

SP 126

Greenfield



"Excellence through Innovation"

OWNER'S MANUAL

Model

Evolution 2000 Mk II A



BRIGGS & STRATTON

17 OHV 34

HONDA 13 OHV 34

Made in
AUSTRALIA
Since 1966

INSTRUCTIONS AND SPARE PARTS

Greenfield Products Pty Ltd

172 Ingram Rd, Acacia Ridge, Qld. Australia 4110. Fax (07) 3344 1161. Phone: (07) 3345 6100

Website: <http://www.greenfield.com.au> — Email: greenfld@gil.com.au

GT200301099

E V O L U T I O N 2 0 0 0 M K I I A

Contents

Safety Instructions	2
Operating Instructions	4
Differential Instructions	6
Maintenance	
General	7
Maintenance	
Blades and Belts	8
Maintenance	
Chains and Steering and Parking Brake	12
Electrical Circuits	15
Spare Parts	
Linkages – Cutter Clutch and Drive Clutch	16
Linkages – Brake, Height Adjust and Notch Bar	17
Engine and Electrics	18
Drive Clutch and Rear Axle	19
Steering and Front Axle	20
Cutter Deck	21
Body Work and Seat	22
Service Record	23
Guarantee	24
Other Greenfield Products	



Greenfield Products Pty Ltd

All details are correct at time of printing but are subject to change without notice.

GF200301099

Evolution 2000

Thank you for buying an Australian made **Greenfield** mini tractor. Follow the manufacturer's operating and maintenance instructions and many years of excellent trouble free service can be expected.

Before operating the mower **read the owners manual carefully.** Do not allow children or any person unfamiliar with the safe operating procedure to operate this mower. Your Greenfield mower has been designed to meet stringent safety standards - but we remind you that a mower is a cutting device - **used incorrectly it could cause personal injury. Remove the key when machine is not in use.**

Safety Instructions

1. Do not carry passengers.
2. Know your controls. Read the operating instructions carefully. Learn how to stop the mower and the engine quickly in an emergency.
3. Do not mow whilst people, especially children or pets are in the mowing area.
4. Make sure the area to be mown is clear of sticks, stones, bottles, bones, wire and other debris which could be thrown by the blades.
5. Do not operate the machine without first inspecting the blades, blade bolts and blade holder for wear or damage. **Damaged blades and worn bolts are major hazards.** Always replace blades and blade bolts in sets to preserve balance. Replace worn or damaged parts with **genuine Greenfield** replacement parts only. N.B. Use of inferior non-genuine service parts on your Greenfield mower could result in costly damage and even personal injury. Refer "Maintenance Instructions", for replacement part numbers and fitting instructions.
6. Before using, check that the grass catcher, safety switches and guards provided by the manufacturer are operating properly and fitted securely. Regularly check all the components on the mower to ensure the machine is in a safe operating condition.
7. Never mow while barefoot or wearing open sandals or thongs. Wear long trousers and heavy shoes. It is also important to wear suitable eye protection.
8. A mower operator should be in good physical and mental health and not under the influence of any drug or alcohol which might impair vision, co-ordination or judgement.
9. Replace worn or faulty exhaust mufflers.
10. Keep the engine free of grass, leaves or excessive grease. These can be a fire hazard.
11. Refuel outdoors only. Do not smoke while fuelling engine. Never remove the cap of the fuel tank or add petrol while the engine is running or if the engine is hot, allow it to cool. Remove fuel cap slowly to relieve any tank pressure. Do not overfill the fuel tank. If petrol is spilled do not attempt to start the engine but move the machine away from the area of the spill and avoid creating any source of ignition until petrol vapours have dissipated.
12. Regularly check the mower for fuel leaks. If a fuel leak is detected, do not start the engine until the fuel leak is fixed and the spilled fuel is wiped away.
13. Do not operate the engine in a confined space where the poisonous exhaust fumes (carbon monoxide) can collect.
14. Always disengage the cutting blades from the operator's seat before starting or stopping the engine.
15. Always mount or dismount the mower from the opposite side to the discharge chute. Always stop the engine before dismounting, keep feet and hands clear of the cutter deck.

16. Exercise extreme caution when mowing on slopes. Reduce speed particularly when making sharp turns to prevent overturning or loss of control. Do not stop or start suddenly when mowing uphill or downhill. The differential action must be locked out when operating on any slope to improve traction and safety.
17. Never operate a ride-on mower across the face of a slope.
18. Stay alert for holes in the terrain and other hidden hazards.
19. Before crossing paths, driveways or any other area foreign to mowers, reduce engine speed disengage cutting blades and lift cutting attachment to maximum height. Do not drive over obstacles or gutters, this machine has a maximum 3 1/2"(9cm) clearance.
20. Watch out for traffic when crossing or operating the mower near roadways. **Always mow with the safety grass deflector properly fitted.**
21. When mowing, never direct discharge of material toward bystanders nor allow anyone near the machine while in operation.
22. Before leaving the operator's position:
 - (a) Disengage the cutting blades.
 - (b) Apply the parking brake.
 - (c) Stop the engine and remove the starter key.
23. Disengage the drive to the cutting blades and stop the engine:
 - (a) Before refuelling
 - (b) Before removing grass catcher or any attachment.
 - (c) Before making a height adjustment unless adjustment is being made from the operator's position.
 - (d) Before clearing blockages.
 - (e) Before inspecting, cleaning or working on the mower.
 - (f) After striking a foreign object (inspect the mower for damage and make necessary repairs before restarting and operating the machine).
 - (g) If the machine starts to vibrate abnormally (check immediately).
24. Disengage drive to the cutting blades when not in use or in transporting.
25. Do not over-speed the engine or alter governor settings. Excessive speed is dangerous and shortens the mower's life.
26. Use care when pulling loads or using attachments.
 - (a) Use only the approved drawbar hitch point.
 - (b) Limit loads to those you can safely control. Maximum gross 110kg.
 - (c) Do not turn sharply. Use care when backing up.
27. Store the mower in a well ventilated room away from naked flames such as may be found in some hot water heaters.
28. Do not lend or sell the mower without the owner's manual.
29. **WARNING** - Remove spark plug lead to avoid accidental starting before attempting any maintenance or inspection of the mower.

Operating Instructions

BEFORE STARTING

Fuel

Top with clean regular **Unleaded** petrol only. **Don't Over Fill.** Make sure the petrol is free from impurities, particularly water. The petrol tank is located inside the engine compartment of your Greenfield. Raise the bonnet for access. Do not use stale petrol in your mower, add clean fresh fuel only.

Engine Oil

Check oil level by positioning the mower on level ground, remove the dipstick and wipe clean, replace the dipstick screwing correctly into position. Remove again and sight the oil level. Fill to the full mark. Do not overfill. Dipstick must be firmly in place when the engine is running. Refer to the "CRANKCASE LUBRICATION" in the maintenance section of this manual for oil recommendations.

Tyres

Inflate to the correct pressures. 20 to 22 psi (140 to 154 KPa) in the front and 12 to 15 psi (84 to 105KPa) in the back tyres. Do not over inflate. Over inflation will permanently change the shape of the tyre adversely affecting the cutter deck Trim & Tilt.

TO START

Apply park brake; disengage blade clutch (Cutters Out). Turn on fuel tap (if fitted). For cold starting set throttle control to "Choke". Turn starter key to start position for **ten (10) seconds, maximum** to avoid overheating of starter motor. If engine does not start it may be flooded. Set throttle control half way then attempt to start again. Make sure to return the key to the RUN position after the engine starts or each time you attempt to start it.

Do not allow children or any person unfamiliar with the safe operating procedure to use this mower. Know your controls. Read the following instructions carefully. Learn how to stop the mower and the engine quickly in an emergency.

Important - This Evolution Model Greenfield mower is fitted with a safety "cut-out" switch activated by the seat. The operator must be seated to start the engine and remain seated while operating the mower. If you don't remain seated the engine will stop. This safety switch must be kept functional for your protection. Adjustment is easily done if ever necessary.

TO STOP

Reduce engine speed to idle on the throttle control, disengage cutter blades (cutters out). The cutter blades should come to a complete stop in approximately 7 seconds (refer Cutter Belt Adjustment). Apply the park brake and allow engine to cool down by idling approximately 20 seconds. Return key to "STOP" position to switch engine off. **Then, and only then, dismount from the driver's seat.** Turn fuel tap off (if fitted).

It is essential that the key is turned to the "STOP" position otherwise current from the battery will keep the fuel cut off solenoid valve on the carburettor open.

TO OPERATE

A simple pivoted foot pedal controls forward, neutral and reverse. Apply toe pressure to move forward, heel pressure to move in reverse. Increased toe or heel pressure provides speed variation in forward or reverse respectively. Allow pedal to centralise for neutral. The drive pedal can also be used as a brake by applying toe or heel pressure opposite to the directional movement of the mower. Sudden or violent directional changes and/or wheel spinning must be avoided.

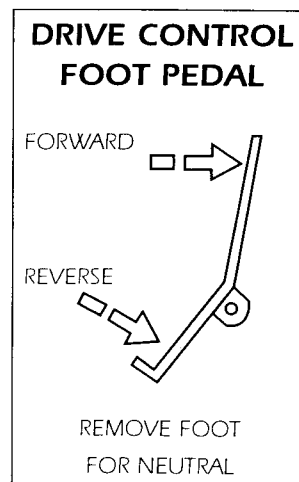

Cutting Height

The height adjustment lever located to the front right of the rear cover enables the operator to select the desired cutting height. To alter the cutting height, move the lever to the right then shift upward or downward to select the setting then release to lock in position. An indicator panel displays the setting. Keep the indicator in the green band for maximum belt life.

Blade Clutch

The blade clutch lever is located on the deck alongside the right hand side running board. To engage the cutting blades, push this lever forward sufficient to release the tension on the latch, raise the release trigger on the lever with fingers and allow the lever to move slowly rearwards to the "ENGAGED" position. To disengage the cutter blades, push the lever fully forward into the locked "OUT" position. To prolong cutter V belt life, engage and disengage the clutch lever slowly.

NEVER USE WITHOUT SAFETY DEFLECTOR OR GRASS CATCHER FITTED.

DANGER: Never attempt to dismount from the driver's seat while engine is running.

Seat

The operator's seat is adjustable front to rear. To adjust, hinge seat forward, loosen seat securing bolts, and move seat to position required and retighten bolts. Oil pivots occasionally.

Disk Brake

The park brake handle is located in front of the left side rear mudguard. This handle has two positions, "OFF" and "ON". To engage the park brake, lift the handle fully up and engage the handle into the parking latch. To disengage, lift the handle up and out of the parking latch and lower to the "OFF" position. This brake can also be used for stopping the mower in an emergency. **DO NOT DRIVE THE MOWER WITH THE BRAKE IN THE "ON" POSITION.**

Check effectiveness of the parking brake by its ability to stop the tractor mower by applying the brake to the "ON" position while it is rolling forward with the foot pedal in the neutral position.

Should the parking brake need adjusting, refer to "BRAKE PAD WEAR ADJUSTMENT" on page 14 of this manual.

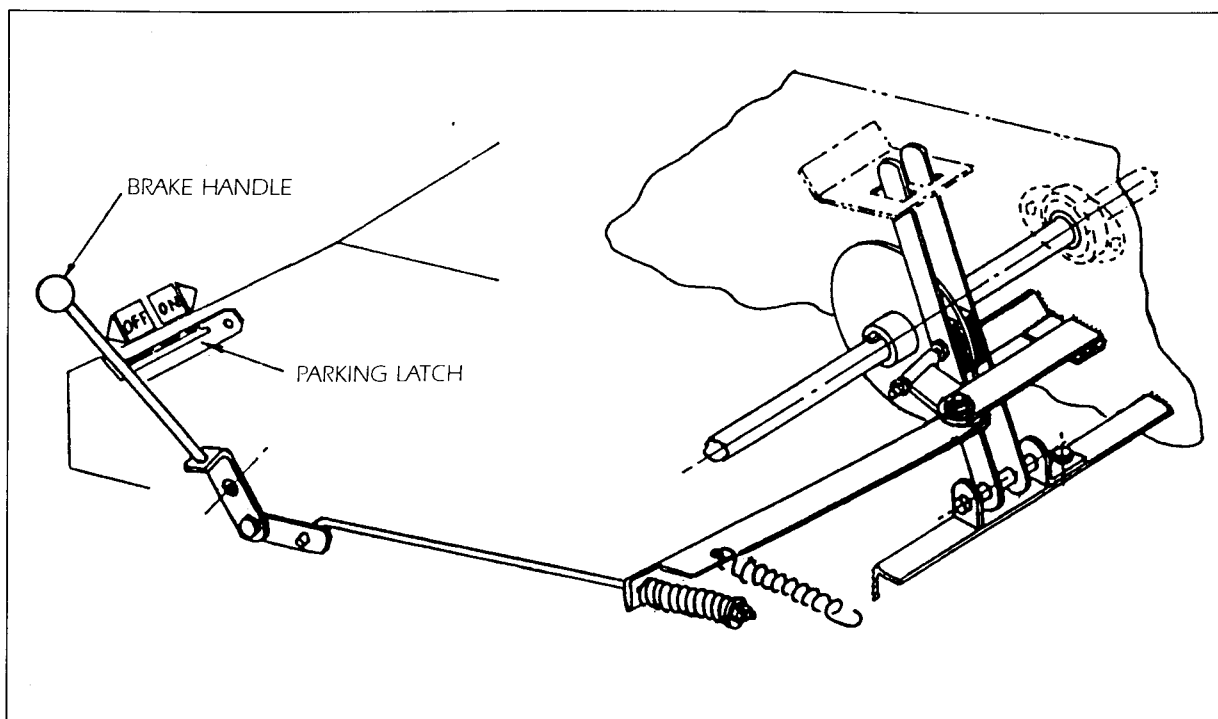

Greenfield Differential

Instructions and Hints

The Greenfield Evolution mower features a unique and patented new type of differential. This differential offers the operator the option of the full differential action of the rear wheels for improved steering and a tight turning circle, whilst eliminating rear wheel scuffing on fine lawns. Most people will run their Greenfield with the differential operating all the time. This is the preferred method of operation and is accomplished by keeping the handle hooked over the end of the rear axle (see "A" below).

Important: Do not attempt to engage or disengage the differential lock from the operator's seat or while the engine is running.

In some situations, such as extremely wet areas or when working on hills you must lock out the differential action for improved traction. You accomplish this by simply releasing the handle from the end of the rear axle. The lock will automatically engage when released (See "B" below).

To return the differential to the operating position (See "A" below) turn the steering wheel either to the left or right; then rock the mower back and forth while simultaneously pulling out on the engagement handle and hook it over the end of the rear axle. Lubricate if necessary.

If the left side rear wheel is removed, make sure the keyed engagement block slides freely into the engagement plate square before the final tightening of the wheel nuts.

Greenfield differentials are fully lubricated and sealed for life at the factory. If the unlikely event that your differential needs service, it must be returned to Greenfield intact. Differentials that have been tampered with or dismantled will NOT be considered for warranty. Normal warranty is 12 months for private use and 3 months for commercial use. Extended warranty is available for up to 3 years for private use or 6 months for commercial use. See your Greenfield dealer for details. Service and spares for the differential are only available through the factory during the warranty period. The factory gives a same day service if a differential is returned.

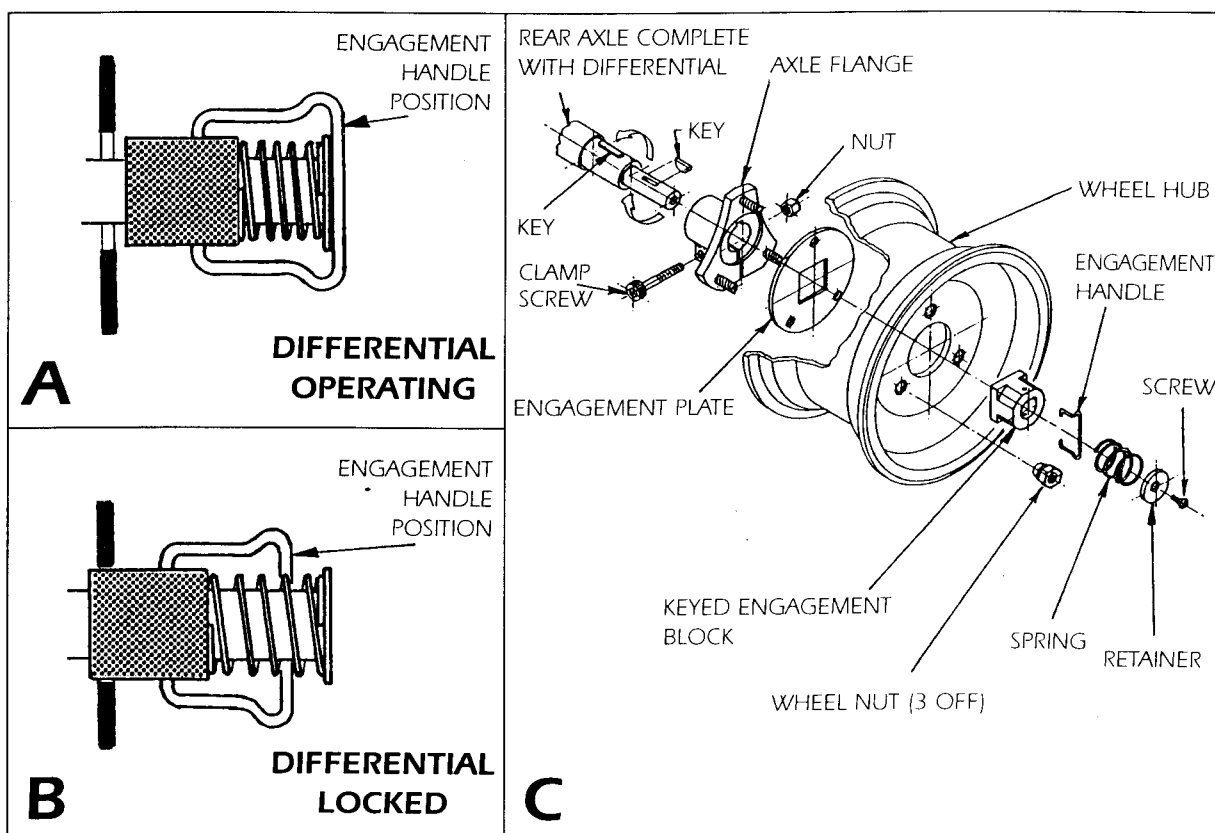

Maintenance

Warning: Remove the spark plug lead to avoid accidental starting BEFORE attempting any maintenance or inspection of the mower.

Crankcase Lubrication

Change engine oil after the first 5 hours of operation then every 6 months or 25 working hours, whichever comes first. Change more often in heavy work or dusty conditions. Drain engine oil whilst engine is warm then replace with a high quality detergent oil classified for service SF/SG by the A.P.I. such as Briggs & Stratton "Warranty Certified" SAE 30 oil, available from Briggs & Stratton Service Dealers.

Fill to full mark indicated on the dipstick. Do not overfill. To check oil level, position the mower on level ground. Remove the dipstick and wipe clean. Replace dipstick screwing correctly into position. Remove again and sight the oil level. The dipstick must be firmly in place when the engine is running. Refer to the engine manufacturers operating booklet for oil recommendations.

Air Filter

Service the air filter as per the engine manufacturers booklet. Clean or replace more often in dusty conditions. Never operate the engine without the air filter correctly and securely fitted - rapid and expensive wear will occur.

Cooling System

Remove the blower housing and clean out the grass and debris to prevent engine overheating. Refer to engine manufacturer's booklet.

Battery

Top with distilled water to correct level as required. If externally charging, care is needed. TRICKLE CHARGE ONLY to avoid battery damage. The maximum charge is 3 AMPS per hour.

Warning: Do not let the battery discharge. If the mower is not used at least once a month, trickle charge regularly to prolong battery life.

Wheels

The rear wheel nuts should be re-tensioned after the first 5 hours of operation to 44Nm (33ft.lbs) then regularly with your preventative maintenance checks. Before re-tensioning the L.H. rear nuts make sure the keyed engagement block slides freely into the engagement plate.

Tyres

Inflate to the correct pressures. 20 to 22 psi (140 to 154 kPa) in the front and 12 to 15 psi (84 to 105 kPa) in the back tyres. Do not over inflate.

Cleaning

Never wash your Greenfield with a high-pressure wash gun. Water and dirt could be blasted past the seals in the bearings causing premature bearing failures and rusted pivot points.

- Never wash your Greenfield immediately after use. The quenching contraction effect from hosing off the machine when it's at operating temperature could also draw water and dirt into the bearings and cause premature bearing failures.
- The best way to clean your Greenfield is to use an air hose to blow the loose grass, etc. from around pulleys' belts and the top of the cutter deck. Wash the exterior with a sponge and bucket, then rinse off with a hose and wipe it down the same as you would your car. For maximum machine life, do not spray water on the pulleys and bearings. Reoil all pivots after wash.
- Allow your Greenfield to cool after use then clean off all grass and other debris before storing. Sticks, stones or an accumulation of grass and other debris will damage belts and fracture pulleys if they go through between the pulley and belt. When operating in these conditions the cutter deck may require more frequent cleaning.

Chassis Lubrication

Your Evolution 2000 Greenfield mower has 3 greasing points. A grease nipple is fitted to each king pin housing in the front axle beam, the third grease nipple is fitted to the steering link idler which is located in the centre of the machine close behind the front axle beam and accessible from under the chassis. Grease these locations every 6 months or 50 operating hours with a quality No 2 lithium base grease or equivalent. It is recommended your grease gun be fitted with a flexible hose. All other exposed pivoting joints; lever points and slides are to be lubricated with engine oil.

BLADES AND BELTS

Belts

Greenfield "V" belts are self-adjusting although the cutter belt may need occasional adjustment within its working lifetime (see page 11). Inspect the "V" belts regularly and replace if damaged. Part Number for "V" belts are -

Drive V Belts GT 20005

Cutter V Belt GT 18005

Important - For long service life, use only Genuine Greenfield branded V belts, refuse substitutes. Non Genuine V Belts may render the clutch ineffective, even dangerous.

Blades

Check condition of blades, blade bolts and blade holder. Replace if damaged or worn. Worn or damaged blades and bolts are major hazards. Always replace worn or damaged blades and bolts in sets to preserve balance. Use only Genuine Greenfield branded replacement parts. Use of inferior non-genuine replacement parts on your Greenfield could result in costly damage or even personal injury.

Part Numbers for Blades and Bolts are:

Cutter Blade and Bolt Set	GT 2139
Cutter Blade and Nut Set	GT 2138
Bolt and Nut Set	GT 2110

To fit new blades refer to illustration A. Tighten the blade bolt nuts firmly. Correct torque is 44Nm. (32ft.lbs). Blades must be free to move but not loose. Lightly oil the blade pivot point before fitting.

Warning: Always remove the spark plug lead to avoid accidental starting.

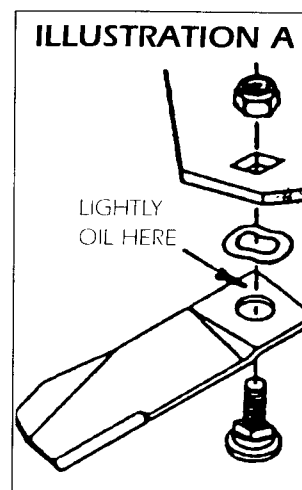

Cutter Deck Adjustments

Before checking "TILT" which is the forward slant on the cutter deck front to rear or "Trim" which holds the cutter deck level side to side first check the tyres are inflated to the correct pressures, the front axle beam is level in the chassis, the rear axle is adjusted correctly, parallel in the chassis and the entire machine including all four wheels are on the same level flat surface.

1. **Remove spark plug lead to prevent accidental starting.**
2. Disengage blade clutch (Cutter Out)
3. Set the "Trim" by raising or lowering the right hand side of the cutter deck by means of the adjusting nut on the support chain.
4. Set the "Tilt" by loosening the tilt adjusting bolts which connect the bottom link to the cutter deck side plates on each side. Set the deck to the correct tilt (minimum 6mm lower at the front) then re-tighten both bolts. See illustration B

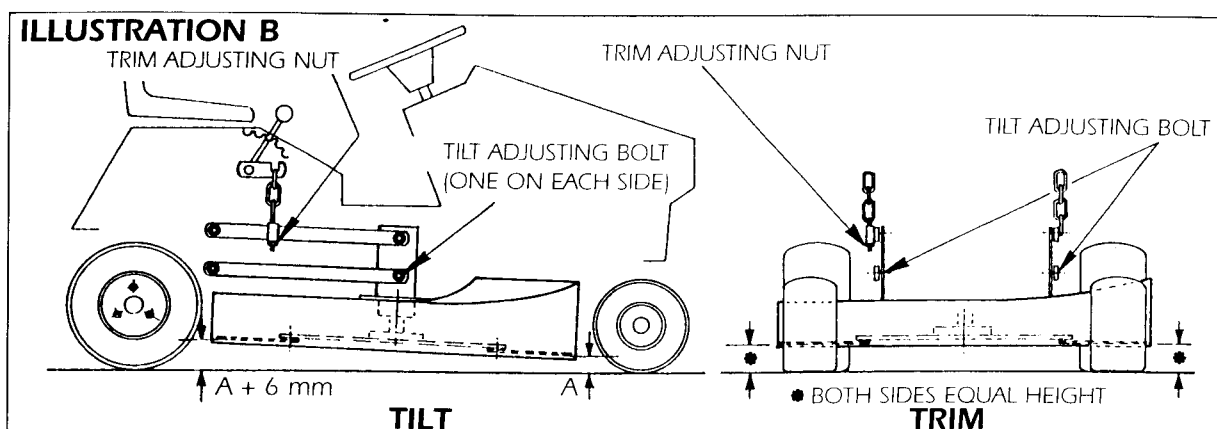

TO REMOVE DRIVE "V" BELT

1. Remove the spark plug lead to prevent accidental starting.
2. Lift up the seat and disconnect the wire to the seat cut out switch by pulling apart the spade connector on the blue wire near the top of the battery. Remove the rear cover by undoing the star knob under the seat and removing the rear cover and seat assembly.
3. Set the blade height to the "LOW" position.
4. Swing back the steady bracket supporting the rear clutch link (refer illustration C).
5. Remove the spring clip from the back end of the clutch yoke. Lift off the rear clutch link and swing rearward (refer illustration D).
6. With the spring release hook tool provided (see illustration E), remove the tension spring from the idler pulley notch bar.
7. Release the notch bar leaf spring by inserting a flat screwdriver through the slot in the bracket above the leaf spring. Lever the leaf spring clear of the notch bar and hold in a released position allowing the idler pulley to slide freely rearward to permit belt removal. (Refer illustration E).
8. To remove the drive V belt from the engine pulley the cutter V belt must first be removed. Follow steps No 1,2,3,4 and 5 of "To remove cutter V belt" instructions. Now remove the drive V belt from the engine pulley.
9. Lift the drive V belt off both flat idler pulleys and remove the belt through the opening at the rear clutch link.

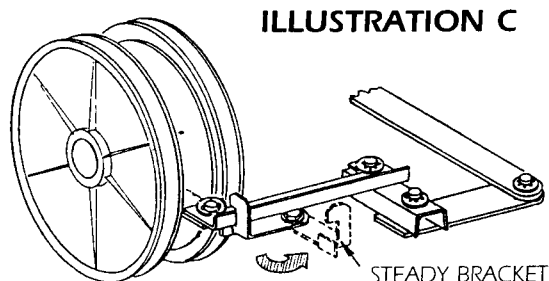

ILLUSTRATION C

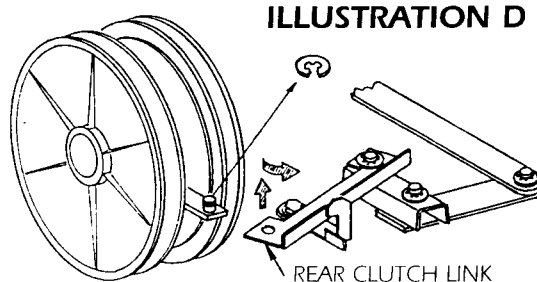

ILLUSTRATION D

ILLUSTRATION E

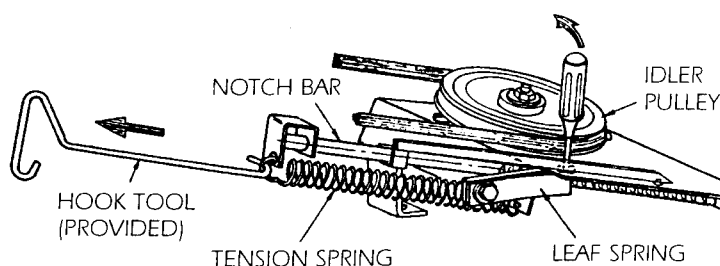
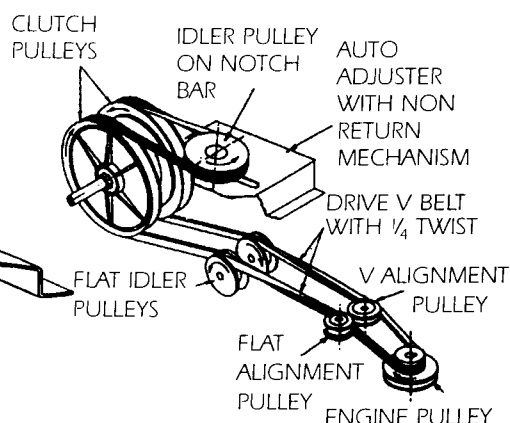

ILLUSTRATION F



TO REPLACE DRIVE V BELT

1. Feed the belt down the back of the clutch pulleys around the flat and "V" alignment pulleys and onto the top groove of the engine pulley. If the cutter V belt is in position on the engine pulley, remove the belt by following steps No 1,2,3,4 and 5 of "To remove cutter V belt" instructions.
2. Fit the belt into both clutch pulleys then into the idler pulley on the notch bar. This pulley will need to be in the fully rearward position. Lubricate the slide with grease.
3. Fit the belt over both flat idler pulleys. The back of the belt runs on the pulleys. See illustration F
4. Replace the notch bar tension spring using the hook tool.
5. Replace the rear clutch link and the spring clip.
6. Swing the steady bracket forward to support the rear clutch link.
7. Refit the cutter V belt into the bottom groove of the engine pulley by following step No 6,7,8 and 9 of "To replace cutter V belt" instructions.
8. Replace the rear cover and reconnect the wire to the seat safety cut out switch.
9. Replace the spark plug lead.

To Remove Cutter V Belt

1. Remove the spark plug lead to prevent accidental starting.
2. Lower the blade height to the "LOW" position and engage the cutters, blade clutch "IN".
3. Working at the back of the mower between the rear wheels, unhook the cutter belt tension spring from the bracket on the rear of the cutter deck using the hook tool provided.
4. Disengage the cutters, Blade clutch "OUT".
5. Remove the V belt from the engine pulley by manoeuvring the belt down between the pulley and the belt guide pins.
6. Remove the V belt from the fixed clutch pulley and the sliding clutch pulley by manoeuvring the belt between the pulleys and belt guides.
7. Remove the V belt from the cutter pulley by manoeuvring the belt up between the pulley and the cutter brake, the pulley and the belt guide leaf spring and guide pin. Remove the belt from the machine.

To Replace Cutter V Belt

- (1) Remove the spark plug lead to prevent accidental starting.
- (2) Lower the blade height to the "LOW" position and engage the cutters, blade clutch "ENGAGED".
- (3) Working at the back of the mower between the rear wheels unhook the cutter belt tension spring from the bracket on the rear of the cutter deck using the hook tool provided.
- (4) Fit the V belt to the cutter pulley by manoeuvring the belt down between the cutter brake and pulley, the front leaf spring and pulley and the guide pin and pulley.
- (5) Fit the belt to the fixed clutch pulley and the sliding clutch pulley by manoeuvring the belt between the guide pins and into the v pulleys.
- (6) Fit the belt to the engine pulley by manoeuvring the belt up between the belt guides and into the bottom groove of the engine pulley. Refer to illustration showing cutter V belt run on page 11.
- (7) Using the hook tool, replace the cutter belt tension spring onto the anchor bolt located in the forward hole in the bracket on the rear of the cutter deck.
- (8) Disengage the cutters, Blade clutch "OUT".
- (9) Replace the spark plug lead.

From the operator's seat, run the engine and engage the cutters to check V belt operation. (refer cutter belt adjustment page 15).

Note - A belt run-in period is required as follows. With the height adjusting lever in the green band (mid height position) engage cutter blades and run for a minimum of ten minutes at medium engine speed. Ideally, a total run-in time would be approximately one hour, during which time you can cut grass, on a mid height position.

Cutter Belt Adjustment

Warning: Remove the spark plug lead to avoid accidental starting BEFORE attempting any maintenance or inspection of the mower.

With the cutter clutch lever in the "OUT" position (disengaged) the cutter belt should be sufficiently disengaged to allow the cutter blades to come to a complete stop in approximately 7 seconds. The correct amount of belt slack and the efficient operation of the cutter brake control this stopping time. The spring-loaded clutch idler pulley maintains the correct belt tension when the blade clutch lever is in the "Engaged" position.

The patented self-adjusting cutter clutch will automatically adjust to compensate for normal wear and stretch of the V belt during its working lifetime.

Should some extraordinary belt stretch occur further manual belt adjustment is available by either loosening the two nyloc nuts on the left side pulley bracket base and sliding bracket rearwards, then retighten nuts, or relocating the pulley to the next rearward hole.

The manufacturer recommends all Greenfields be returned to your authorised Greenfield dealer for normal servicing ie. Oil changes, air filters etc., at the times indicated in the maintenance section and by the engine manufacturer. The manufacturer also recommends a maintenance and safety inspection be performed ever 6 months or every 50 working hours by your authorised Greenfield dealer to comply with the conditions for both standard and extended warranty offered by the manufacturer. Refer to warranty leaflet.

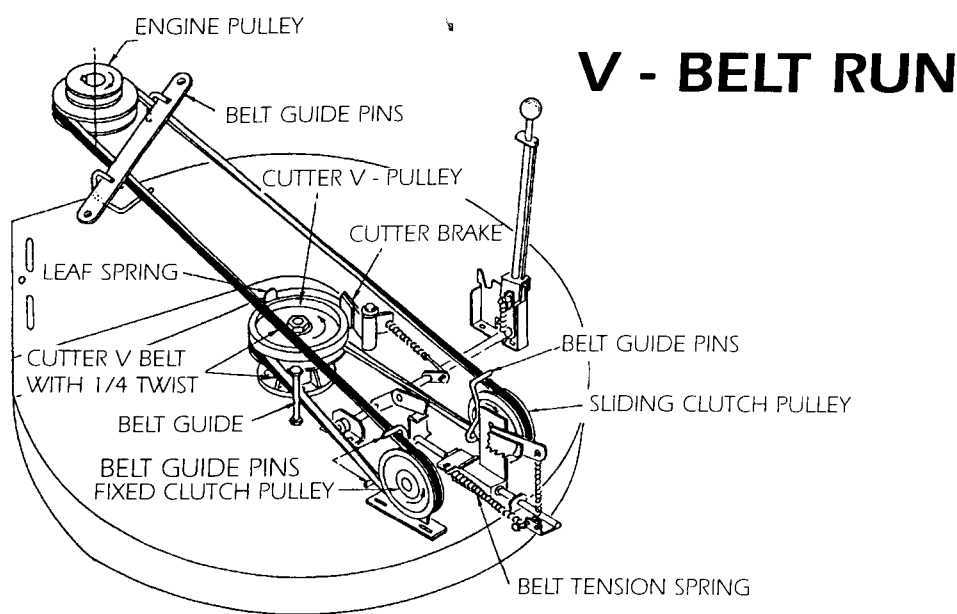

FITTING IDLER PULLEYS

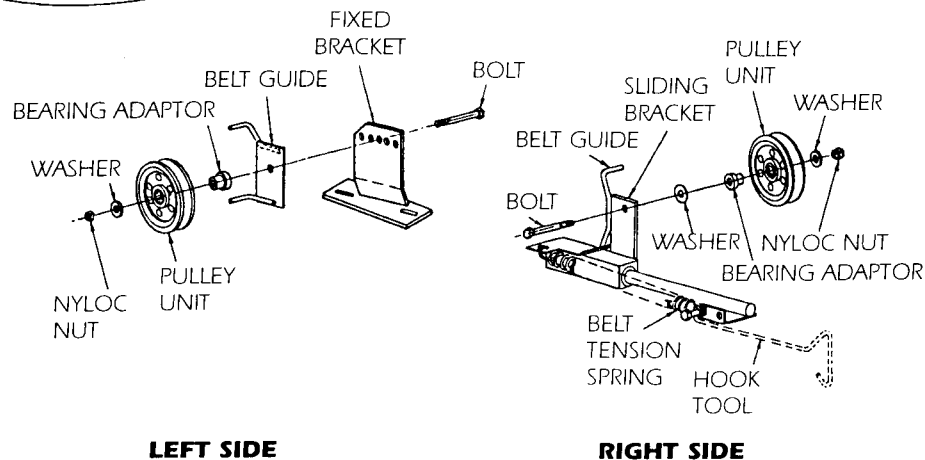

Chains and Brakes

Steering Chain Adjustment

1. Remove the spark plug lead to prevent accidental starting.
2. Lower the cutter deck to "LOW" position.
3. Working from under the bonnet at the rear of the engine from the right hand side, loosen both nyloc nuts on the steering shaft flangette bearing plates and the nyloc nut on the locking tab. See illustration "G".
4. With fingers only, push the steering shaft to the left side of the machine to tighten the steering chain, remove all slackness from the chain. Do not overtighten.
5. Re-tension the two nuts on the bearing plate and the nut on the locking tab.
6. Replace the spark plug lead.

ILLUSTRATION G

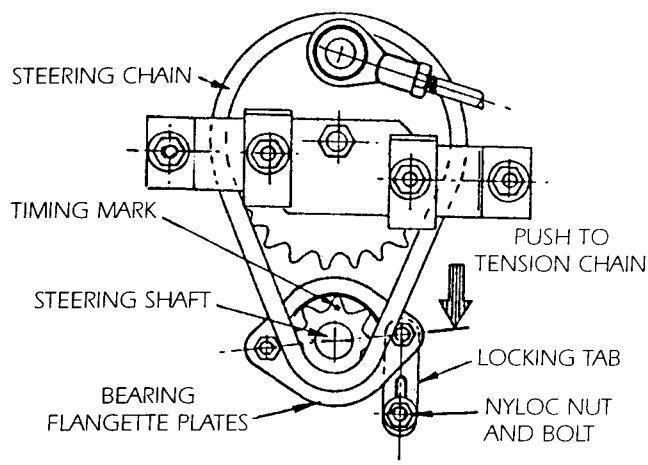

STEERING CHAIN ADJUSTMENT (Viewed from underside of machine)

Rear Drive Chain Adjustment

1. Remove the spark plug lead to prevent accidental starting.
2. Lift up seat and disconnect the wire to the seat cut out switch by pulling apart the spade connector on the blue wire near the top of the battery. Remove the rear cover by undoing the star knob under the seat base and removing the rear cover and seat assembly.
3. Raise and block up the rear of the mower.
4. **Loosen the two bearing mounting plates on each side.** See illustration "J".
5. Adjust the chain by turning the adjusting nuts positioned at the bottom of the rear axle side plates clockwise to tighten the chain. It is very important to adjust each side evenly so the rear axle remains parallel to the mower chassis and the sprockets are in alignment. It is suggested that you turn each nut no more than a quarter of a turn at a time alternating between the two until the chain has 3 mm slack as shown in illustration "H". Do not overtighten the chain.
6. Re-tension the rear axle flangette bearing mounting plate bolts.
7. Re-fit and tension the rear wheels to 44Nm (33 ft.lbs).
8. Replace rear cover, and reconnect the blue wire to the safety switch and replace the spark plug lead.

ILLUSTRATION H

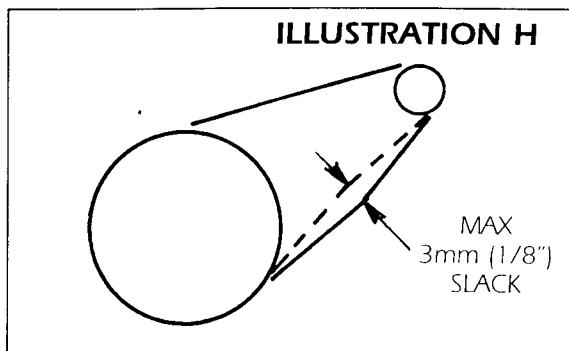
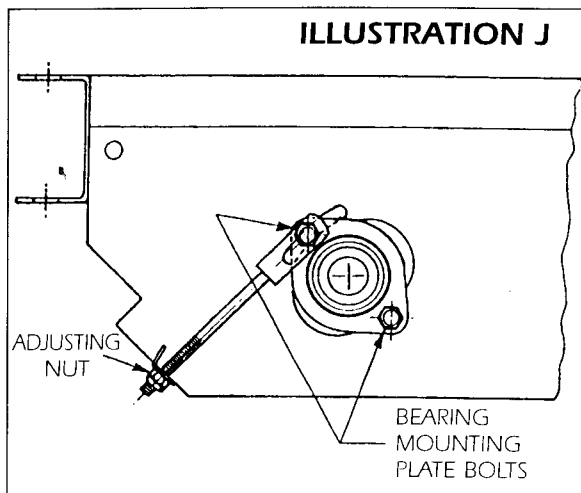

ILLUSTRATION J



REAR DRIVE CHAIN ADJUSTMENT

Note: The rear drive chain should be removed, thoroughly cleaned in kerosene and soaked in a quality chain oil every 50 operating hours, more often if hosed. Refit drive chain and adjust as described in "REAR DRIVE CHAIN ADJUSTMENT". If the rear drive chain is cleaned and oiled regularly, a much longer service life can be expected from the chain and sprockets.

Steering Stop Adjustment

The steering stops "B" are readily seen and accessible from under the right hand side of the chassis with the cutter deck in the "LOW" position. Adjustments should not be necessary, unless the steering has been damaged.

1. Remove the spark plug lead to prevent accidental starting.
2. Check the front wheel alignment has 0-1.5mm toe-in. Correct if necessary by resetting the adjustable tie rod. Toe-in must be correct before any adjustments are made.
3. Loosen the nuts retaining the two steering stops on the chain sprocket support (refer illustration K, item B).
4. Turn the steering wheel full lock to the right till the right hand king pin is hard against the fixed stop "A".
5. Slide the right side stop on the chain wheel support until it hits against the tie rod end "C". Retighten the locking nut "B".
6. Turn the steering wheel full lock to the left then repeat step 5 listed above.
7. To check your adjustments are correct, turn the steering wheel to either lock, noting stops "A" and "B" make contact at the same moment. This will ensure the smallest turning circle without unnecessary strain on the steering component.
8. Replace the spark plug lead.

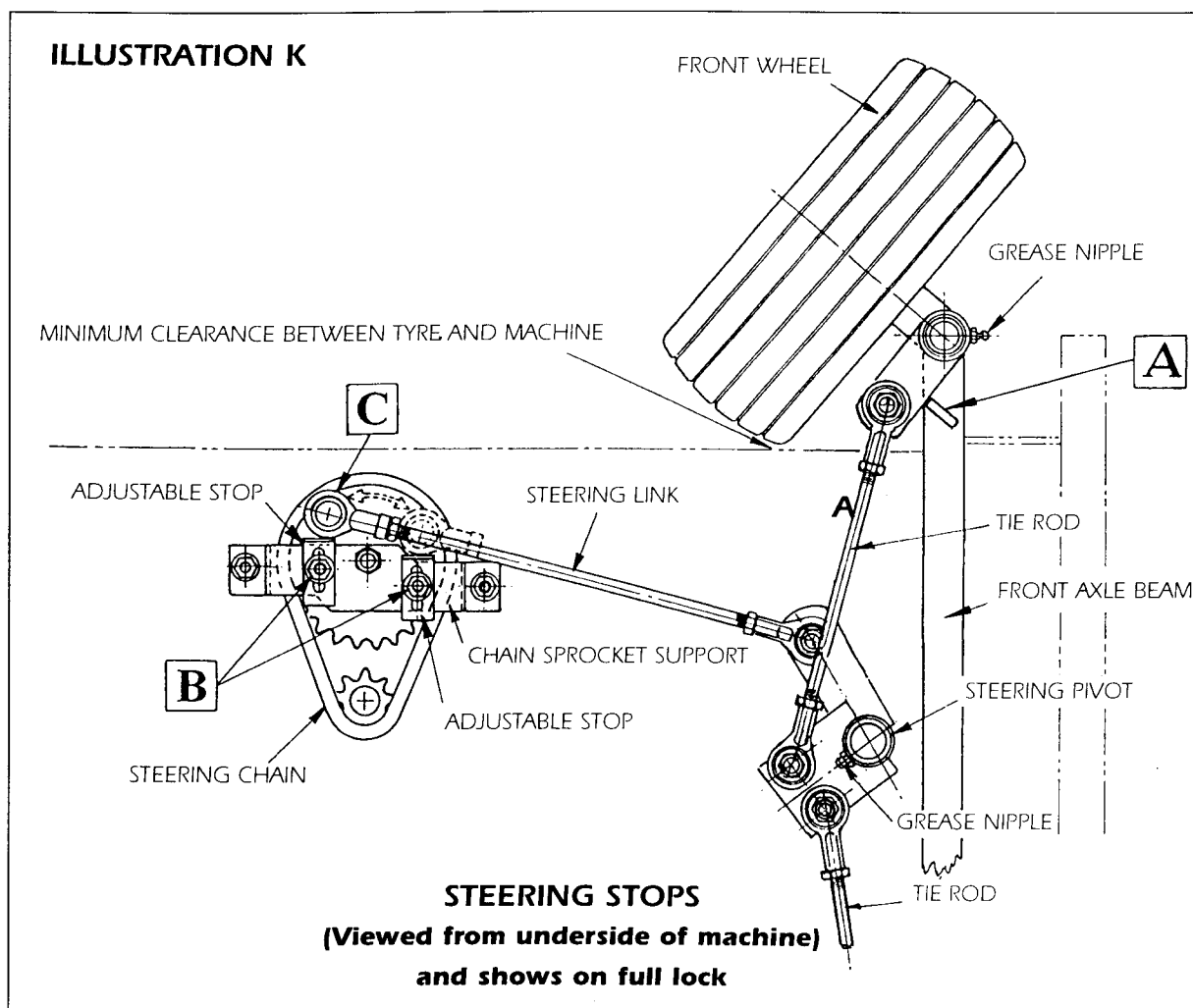

Park Brake Adjustment

Check effectiveness of the parking brake by its ability to stop the tractor mower by applying the brake to the "IN" position while it is rolling forward with the foot pedal in the neutral position.

Brake Pad Wear Adjustment

The adjusting screw is located on the brake arm and bears against the sliding brake pad. As the brake pads wear, the brake disc is free to slide along the axle against the fixed pad. This adjusting screw compensates for wear on both pads and at times will need to be adjusted as described below.

- Remove the spark plug lead to prevent accidental starting.
- Place the brake handle in the "OFF" position.
- Loosen the locknut and screw out the adjusting screw until both pads are just lightly touching the brake disc and not binding.
- Tighten locknut while holding adjusting screw stationary.
- Check that the brake disc rotates freely between the pads and replace the spark plug lead.

Pad Replacement

- Remove the spark plug lead to prevent accidental starting.
- Remove the pad retainer.
- Remove both brake pads.
- Loosen the locknut on the adjusting screw and screw in the adjusting screw. The new pads will be thicker.
- Fit the two new brake pads.
- Refit the pad retainer.
- Re adjust the adjusting screw following steps "A" to "E" of "PARK BRAKE ADJUSTMENT". See illustration "L".
- Oil all pivots, **DO NOT OIL BRAKE PADS OR DISC.**

ILLUSTRATION L

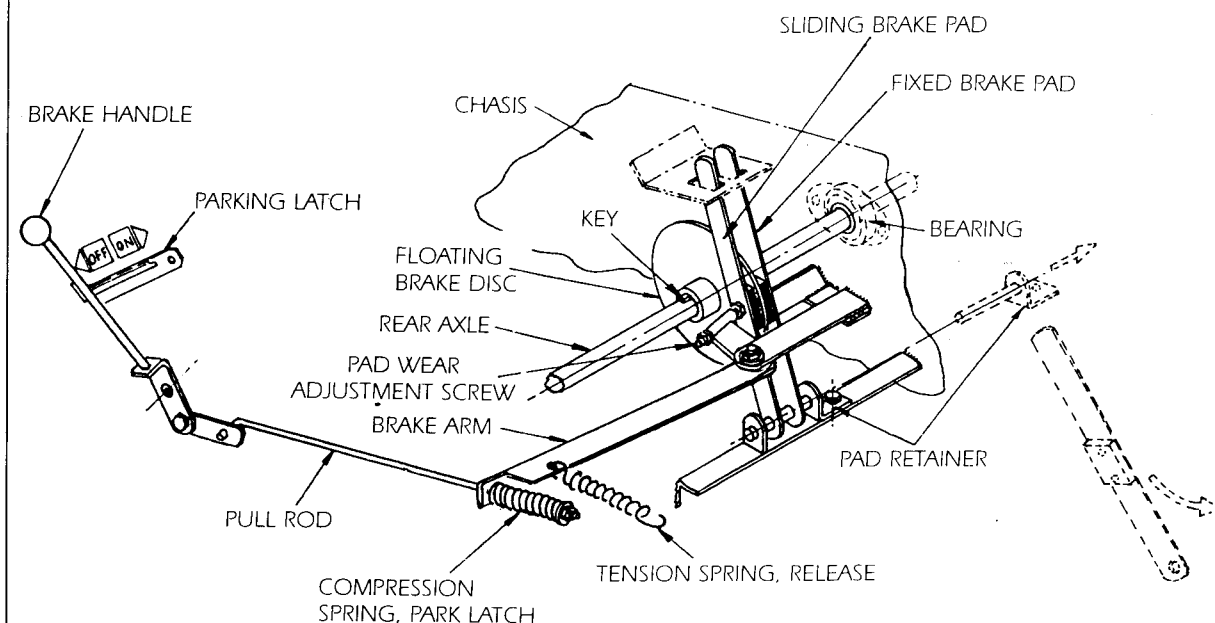

Electrical Circuits

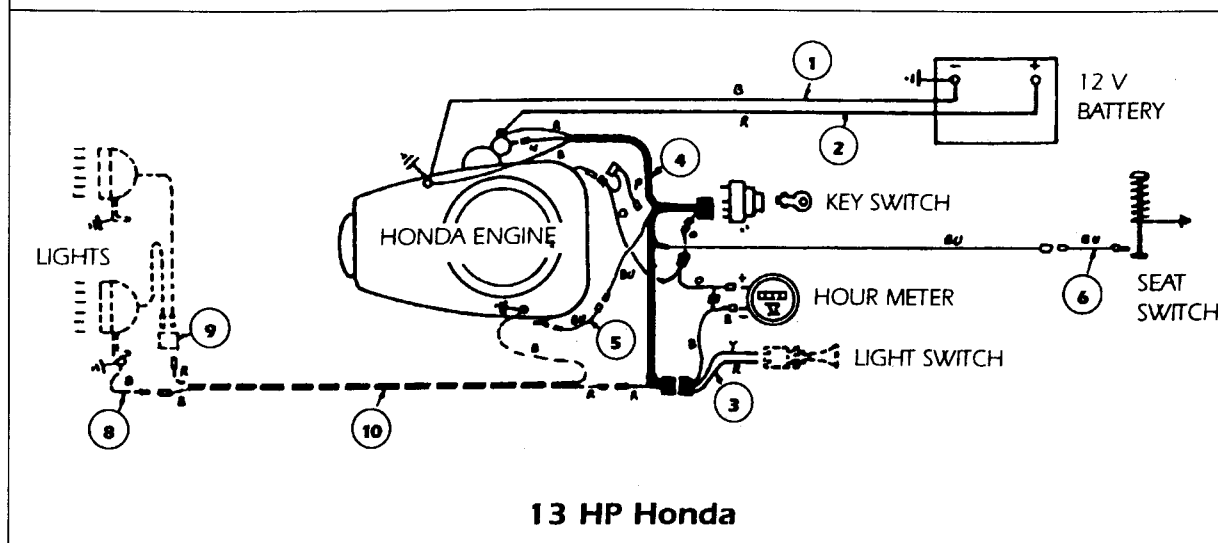
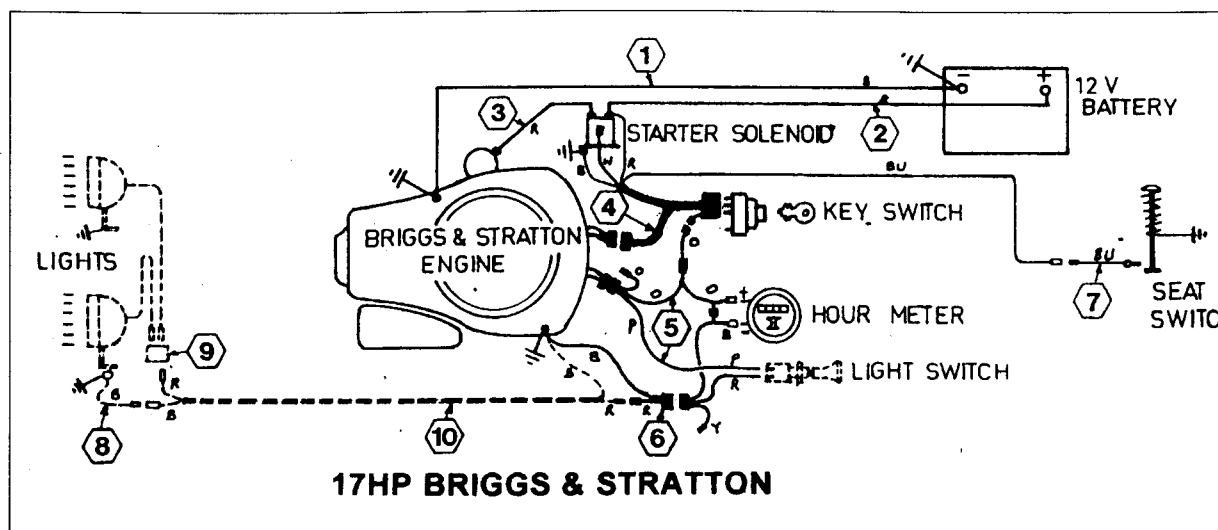

17HP BRIGGS & STRATTON

INDEX PART NO. DESCRIPTION

1.	GT 14370	Black Cable - Batt. To Engine Ground
2.	GT 06129	Red Cable + Batt. To Solenoid
3.	GT 14364	Red Cable Solenoid to Starter
4.	GT 20158	Harness - Key Switch
5.	GT 20173	Harness - Charge And Ac Power
6.	GT 20174	Harness
7.	GT 12066	Blue Wire - Seat Switch
8.	GT 06132	Black Wire -
9.	GT 06167	Connector
10.	GT 14395	Harness

INDEX PART NO. DESCRIPTION

1.	GT 14370	Black Cable - Batt. To Engine Ground
2.	GT 20159	Red Cable + Batt To Solenoid
3.	GT 20173	Harness Hour Meter Lights
4.	GT 14382	Harness - Key Switch
5.	GT 06142	Blue Wire - Engine Cut Out
6.	GT 12066	Blue Wire - Seat Switch

Note These wires are supplied with the Head Light Kit Part No. GT 15841

PARTS AND SPECIFICATIONS SUBJECT TO CHANGE WITHOUT NOTICE.
STANDARD HARDWARE ITEMS ARE NOT SHOWN.

COLOUR LEGEND

B	-Black
O	-Orange
P	-Purple
R	-Red
W	-White
Y	-Yellow
BU	-Blue

Linkages

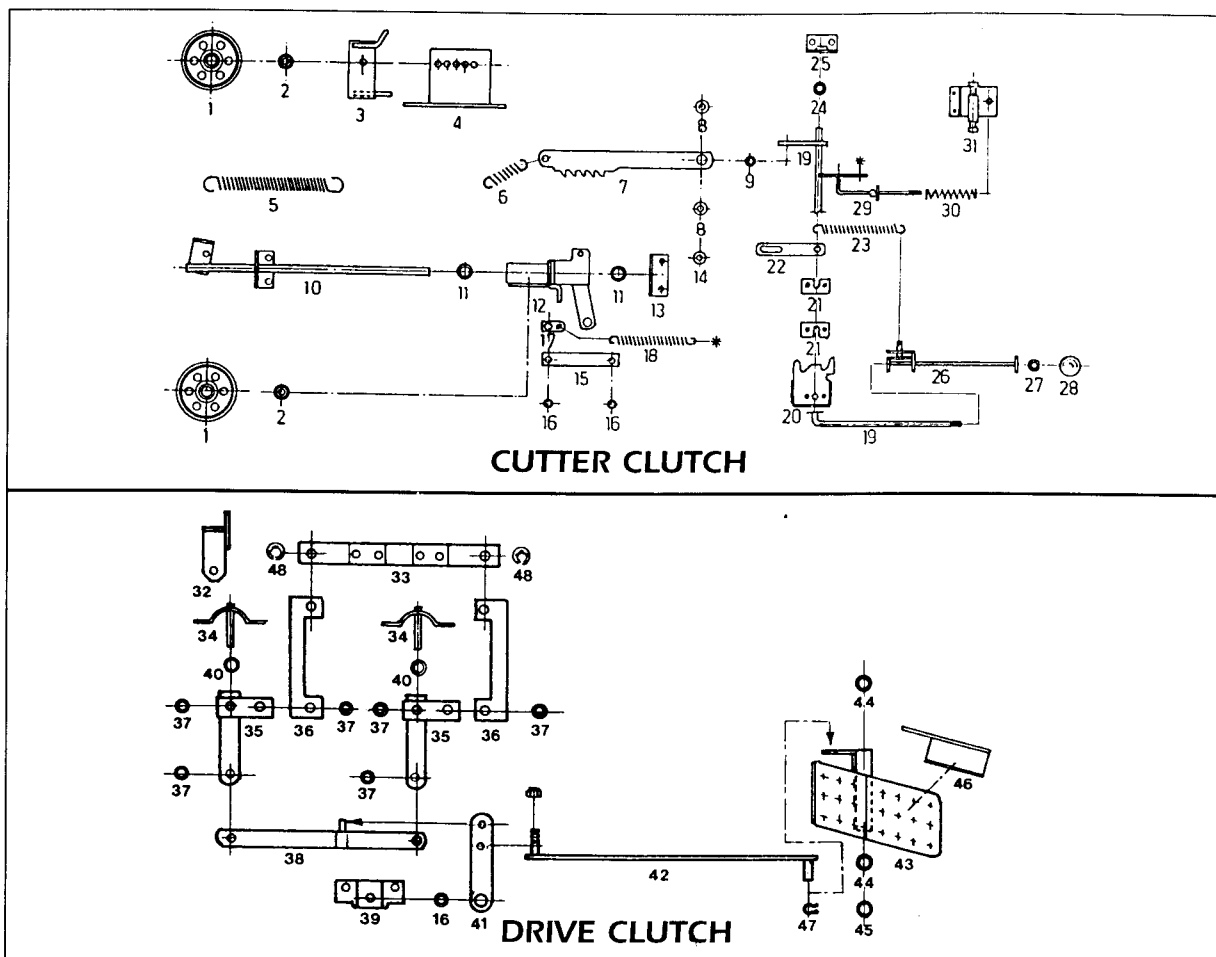

INDEX PART NO. DESCRIPTION

1.	GT 6901	V Pulley & Bearing Complete
2.	GT 6018	Bearing Adaptor
3.	GT 20380	L.H. Belt Guide
4.	GT 18855	Fixed Pulley Bracket Assembly
5.	GT 20006	Spring - Belt Tension
6.	GT 20012	Spring - Clutch Arm
7.	GT 20375	Clutch Arm
8.	GT 2483	Brass Washer
9.	GT 20007	Brass Bush
10.	GT 20365	Slide Rail Assembly
11.	GT 1179	Bush
12.	GT 20385	Sliding Bracket Assembly
13.	GT 20164	Bracket
14.	GT 1012	Washer
15.	GT 14318	Bar (2 required)
16.	GT 730	Bush
17.	GT 5056	Tab - Spring
18.	GT 21004	Spring - Clutch Shaft Return
19.	GT 20425	Clutch Shaft Assembly
20.	GT 20415	Latch - Cutter Clutch
21.	GT 20427	Bearing Plate
22.	GT 20428	Retainer
23.	GT 20015	Spring - Tension
24.	GD 5525	Bush

INDEX PART NO. DESCRIPTION

25.	GT 12305	Bracket
26.	GT 20420	Clutch Release Handle
27.	GD 5526	Bush
28.	GT 1565	Knob
29.	GT 18303	Cutter Brake
30.	GT 12032	Spring - Compression
31.	GT 19801	Cutter Brake Unit
32.	GT 18860	Steady - Clutch Yoke
33.	GT 13833	Yoke Unit
34.	GT 20395	Pivot Pin Assembly
35.	GT 20405	Pivot Arm Assembly
36.	GT 14309	Clutch Link
37.	GT 2057	Retainer
38.	GT 18785	F - R Link
39.	GT 18337	Pivot Bracket
40.	GT 6061	Washer
41.	GT 18318	Link
42.	GT 20390	FR Control
43.	GT 18945	Foot Pedal
44.	GT 12394	Bush
45.	GT 580	Retainer (2 required)
46.	GT 18328	Heat Shield
47.	GT 137	Circlip
48.	GT 2036	Spring Clip

PARTS AND SPECIFICATIONS SUBJECT TO CHANGE WITHOUT NOTICE.
STANDARD HARDWARE ITEMS ARE NOT SHOWN.

Linkages

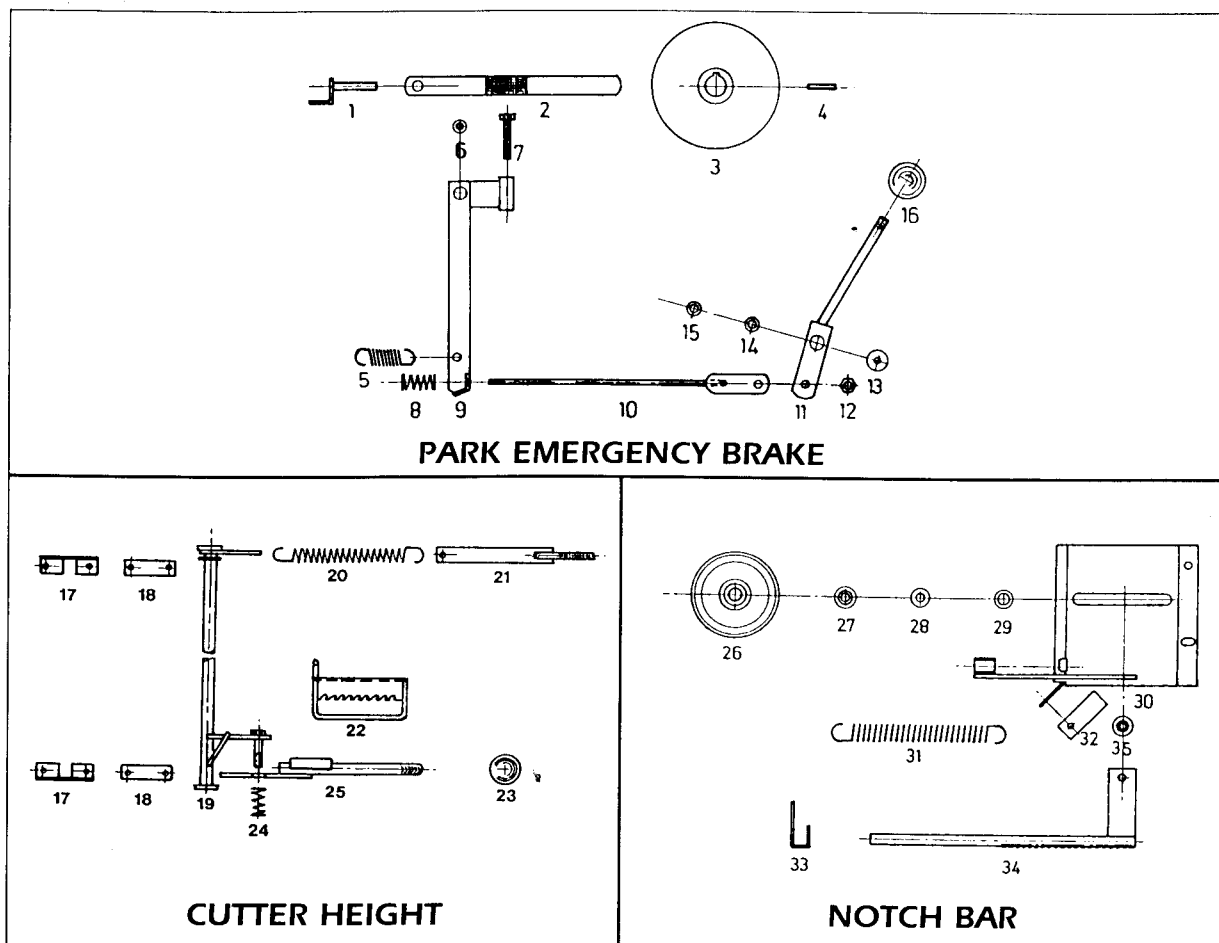

INDEX PART NO. DESCRIPTION

1.	GT 15270	Anchor - Brake Pads
2.	GT 19805	Brake Pad Unit
3.	GT 18660	Brake Disc
4.	GT 12093	Key
5.	GT 20009	Spring - Tension
6.	GT 1851	Pivot Bush
7.	GT 1137	Adjusting Screw
8.	GT 18048	Spring - Compression
9.	GT 19005	Brake Arm
10.	GT 18805	Brake Rod
11.	GT 18980	Brake Handle
12.	GT 2466	Nyloc Nut
13.	GT 579	Wave Washer
14.	GT 730	Pivot Bush
15.	GT 14341	Washer
16.	GT 1565	Knob
17.	GT 18313	Pivot Bracket
18.	GT 18314	Packer

INDEX PART NO. DESCRIPTION

19.	GT 18820	Height Adjust Shaft
20.	GT 20006	Spring Tension
21.	GT 18775	Tensioner
22.	GT 18995	Height Adjust Rack
23.	GT 1565	Knob
24.	GT 7071	Spring - Compression
25.	GT 18705	Handle
26.	GT 7965	V Pulley Complete
27.	GT 610	Bearing Adaptor
28.	GT 579	Wave Washer
29.	GT 18322	Washer
30.	GT 18760	Bracket
31.	GT 20006	Spring - Tension
32.	GT 14023	Leaf Spring
33.	GT 7308	Anchor - Spring
34.	GT 18765	Notch Bar
35.	GT 608	Slide Bush

PARTS AND SPECIFICATIONS SUBJECT TO CHANGE WITHOUT NOTICE.
STANDARD HARDWARE ITEMS ARE NOT SHOWN.

Engine and Electrical

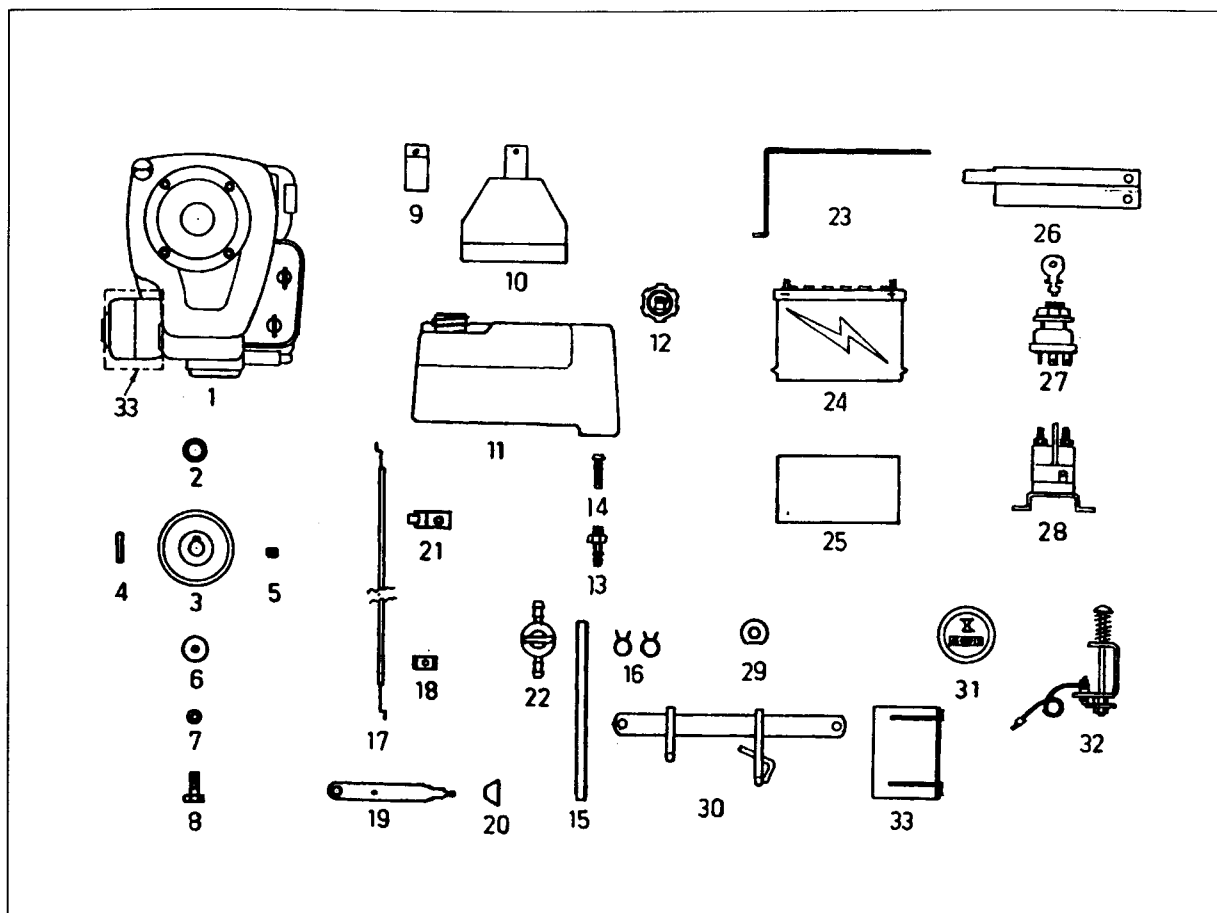

INDEX PART NO. DESCRIPTION

1.		Engine 17HP OHV Briggs & Stratton
1.		Engine 13HP OHV Honda
2.	GT 18047	Spacer - Crankshaft
3.	GT 20003	Pulley - Engine
4.	GT 14037	Key
5.	GT 00520	Grub Screw
6.	GT 01750	Washer
7.	GT 02021	Spring Washer
8.	GT 01069	Bolt
9.	GT 20179	Clamp - Fuel Tank
10.	GT 18870	Support - Fuel Tank
11.	GT 02250	Fuel Tank - Bare
12.	GT 02249	Cap - Fuel Tank
13.	GT 02252	Hose Tail
14.	GT 20185	Filter
15.	GT 14324	Fuel Hose
16.	GT 02024	Hose Clip
17.	GT 20913	Throttle Cable Unit 17HP B & S
17.	GT 15817	Throttle Cable Unit 13HP Honda

INDEX PART NO. DESCRIPTION

18.	GT 01252	Cable Clamp
19.	GT 20169	Throttle Lever
20.	GT 02025	Throttle Knob
21.	GT 14359	Bracket Throttle Cable (Honda only)
22.	GT 02215	Fuel Tap - when fitted
23.	GT 14350	Battery Clamp
24.	GT 01914	Battery
25.	GT 14336	Rubber Mat - Battery
26.	GT 20176	Support - Electric Harness
27.	GT 02219	Off-On-Start - Key Switch
28.	GT 02220	Starter Solenoid (B&S only)
29.	GT 12345	Insulator - Battery + Pole
30.	GT 20280	Belt Guide - Engine Pulley
31.	GT 06084	Hour Meter
32.	GT 13831	Seat Safety Switch Unit
33.	GT 15180	Heat Shield (17HP B & S only)

PARTS AND SPECIFICATIONS SUBJECT TO CHANGE WITHOUT NOTICE.
STANDARD HARDWARE ITEMS ARE NOT SHOWN.

Drive Clutch and Rear Axle

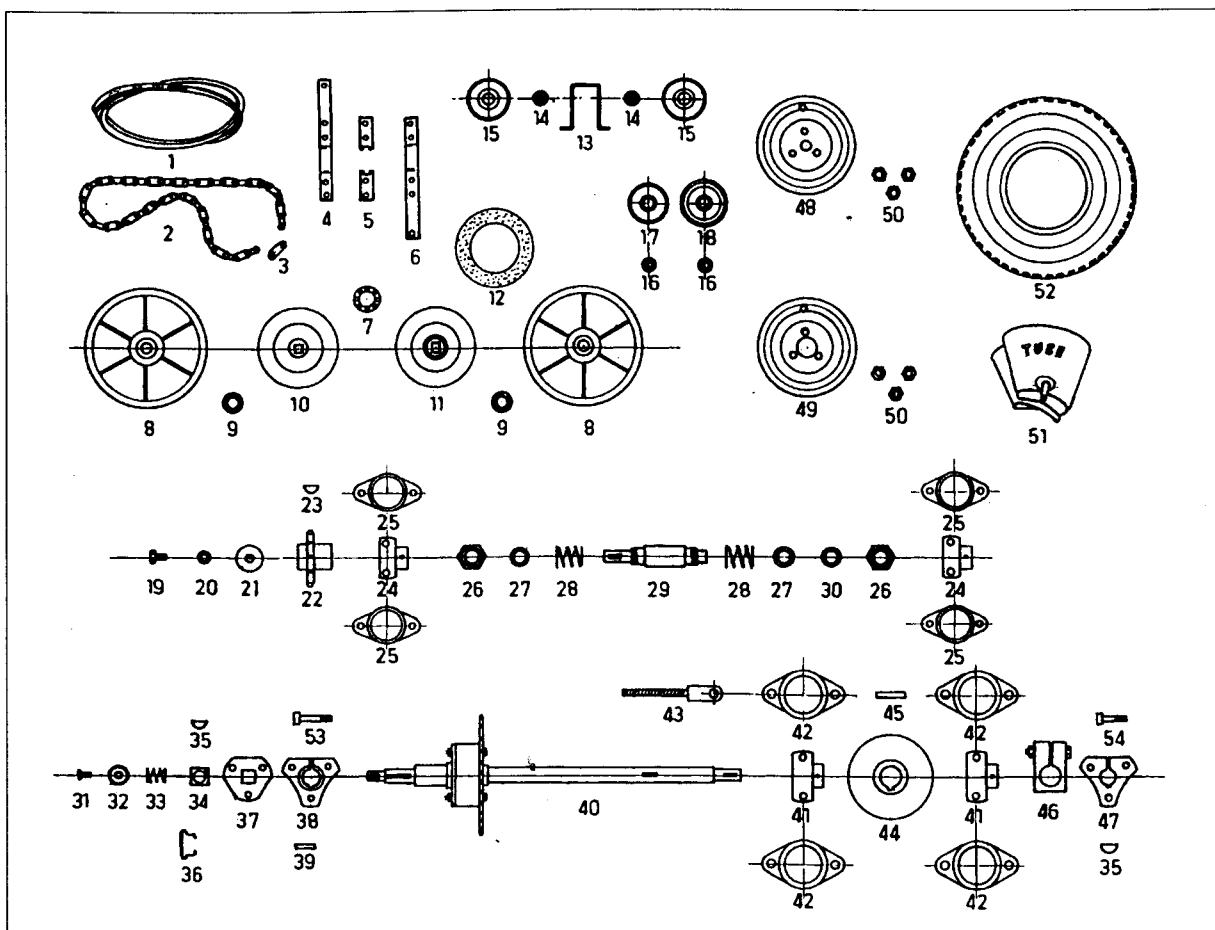

INDEX PART NO. DESCRIPTION

1.	GT 20005	V Belt - Drive
2.	GT 18006	Roller Chain
3.	GT 0050	Connecting Link
4.	GT 10620	Yoke top Half
5.	GT 12364	Retainer
6.	GT 10630	Yoke Bottom Half
7.	GT 00855	Ball Bearing - Drive Plate
8.	GT 00920	Clutch Pulley Complete
9.	GT 02206	Ball Bearing - Clutch Pulley
10.	GT 06855	L.H. Drive Plate (Reverse)
11.	GT 06856	R.H. Drive Plate (Forward)
12.	GT 06012	Clutch Lining
13.	GT 18312	Bracket
14.	GT 18050	Bearing Adaptor
15.	GT 01009	Flat Idler Pulley Unit (Metal)
16.	GT 20004	Bearing Adaptor
17.	GT 06171	Flat Idler Unit (Poly)
18.	GT 14002	V idler Pulley Unit (Poly)
19.	GT 01455	Set Screw
20.	GT 02052	Spring Washer
21.	GT 07306	Washer
22.	GT 12102	10 Tooth Sprocket
23.	GT 00517	Key
24.	GT 00392	Ball Bearing
25.	GT 07017	Flangette Plate
26.	GT 00347	Nut
27.	GT 07303	Washer

INDEX PART NO. DESCRIPTION

28.	GT 00357	Spring
29.	GT 18031	Drive Shaft
30.	GT 00539	Shim
31.	GT 02425	Screw
32.	GT 10488	Spring Retainer
33.	GT 02958	Spring
34.	GT 02956	Engagement Block
35.	GT 00516	Key
36.	GT 02957	Handle
37.	GT 02955	Engagement Plate
38.	GT 02954	Wheel Flange (Differential Side)
39.	GT 02995	Key
40.	GT 02850	Rear Axle & Differential Unit
41.	GT 00390	Ball Bearing
42.	GT 07083	Flangette Plate
43.	GT 18865	Chain Adjuster
44.	GT 18660	Brake Disc
45.	GT 12093	Key
46.	GT 07032	Clamp
47.	GT 01625	Wheel Flange
48.	GT 01624	Wheel Hub Right Side
49.	GT 02929	Wheel Hub Left Side
50.	GT 02011	Wheel Nut
51.	GT 01535	Tube
52.	GT 01203	Tyre
53.	GT 02478	Cap Screw H.T.
54.	GT 02015	Cap Screw H.T.

PARTS AND SPECIFICATIONS SUBJECT TO CHANGE WITHOUT NOTICE.
STANDARD HARDWARE ITEMS ARE NOT SHOWN.

Steering and Front Axle

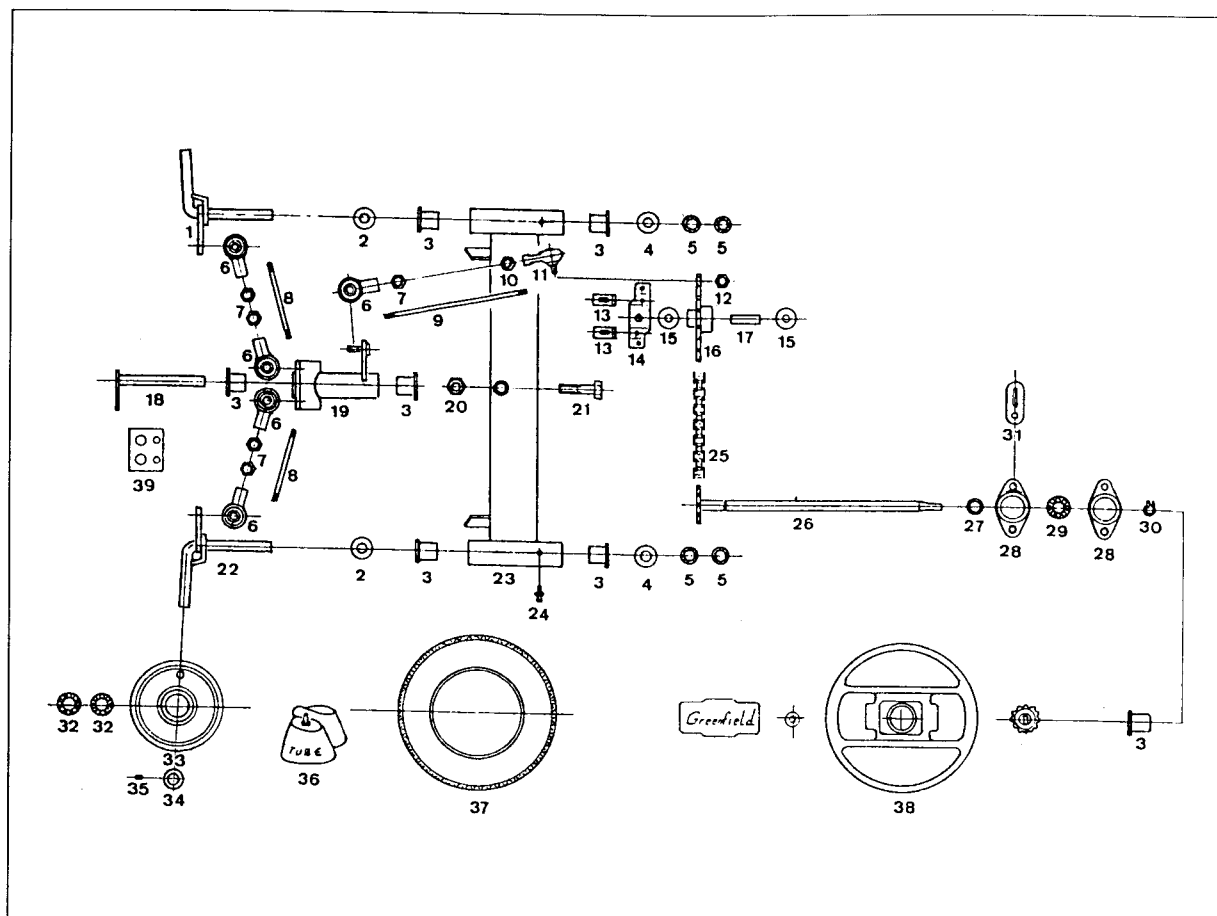

INDEX PART NO. DESCRIPTION

1.	GT 20495	R.H. King Pin
2.	GT 07304	Washer
3.	GT 01766	Bush
4.	GT 07304	Washer
5.	GT 00580	Retainer
6.	GT 01626	Tie Rod End
7.	GT 00078	Lock Nut
8.	GT 20028	Tie Rod
9.	GT 20010	Steering Link - Rod
10.	GT 02406	Lock Nut
11.	GT 06044	Tie Rod End
12.	GT 02090	Nyloc Nut
13.	GT 18317	Stops - Adjustable
14.	GT 18329	Support
15.	GT 02483	Brass Washer
16.	GT 20445	Chain Wheel
17.	GT 20024	Bush
18.	GT 18645	Pivot Pin
19.	GT 20480	Steering Crank
20.	GT 02042	Nyloc Nut
21.	GT 02476	Bolt

INDEX PART NO. DESCRIPTION

22.	GT 20505	L.H. King Pin
23.	GT 20470	Axle Beam
24.	GT 01924	Grease Nipple
25.	GT 13813	Roller Chain
26.	GT 18880	Steering Shaft
27.	GT 20018	Spacer
28.	GT 07017	Flangette Plate
29.	GT 07010	Bearing
30.	GT 02470	Circlip
31.	GT 18324	Locking Tab
32.	GT 00396	Ball Bearing
33.	GT 07007	Wheel Hub
34.	GT 07009	Collar
35.	GT 00520	Grub Screw
36.	GT 00456	Tube
37.	GT 00455	Tyre
38.	GT 02212	Steering Wheel Complete
39.	GT 20183	Reinforcing Plate

PARTS AND SPECIFICATIONS SUBJECT TO CHANGE WITHOUT NOTICE.
STANDARD HARDWARE ITEMS ARE NOT SHOWN.

Cutter Deck 34"

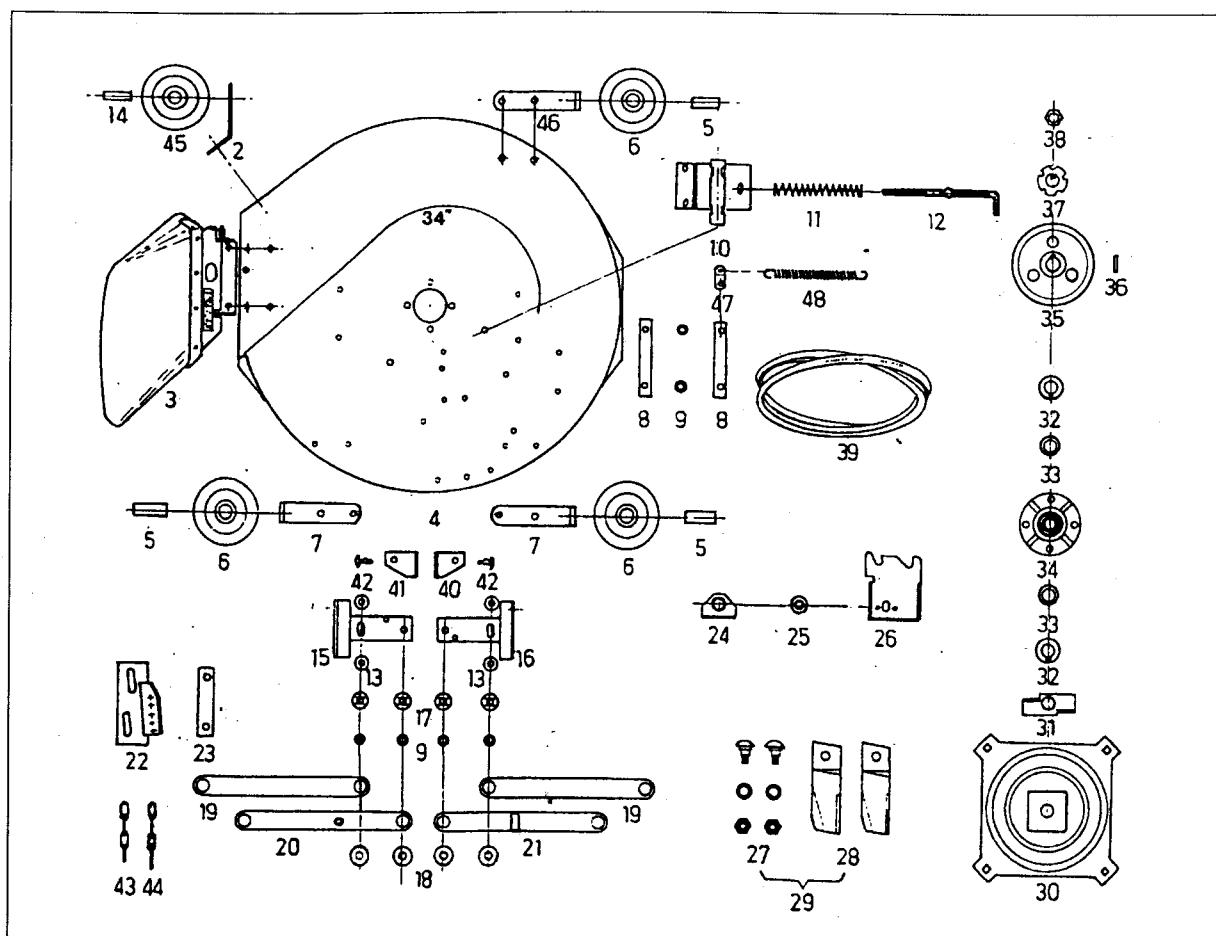

INDEX PART NO. DESCRIPTION

1.	GT 20916	Cutter Deck Complete*
2.	GT 20180	Bracket
3.	GT 20936	Stone Guard
4.	GT 20162	Cutter Deck 34"
5.	GT 20050	Bush
6.	GT 02264	Jockey Wheel
7.	GT 12362	Bracket
8.	GT 14318	Bar
9.	GT 00730	Bush
10.	GT 19801	Cutter Brake Unit
11.	GT 12032	Spring - Compression
12.	GT 18303	Cutter Brake Rod
13.	GT 01567	Spring Washer
14.	GT 20049	Bush
15.	GT 18955	L.H. Side Plate
16.	GT 18955	R.H. Side Plate
17.	GT 00579	Wave Washer
18.	GT 01012	Washer
19.	GT 18966	Bottom Link
20.	GT 18835	L.H. Top Link
21.	GT 18965	R.H. Top Link
22.	GT 18855	Fixed Bracket
23.	GT 13280	Bolt Retainer
24.	GT 12305	Bracket

INDEX PART NO. DESCRIPTION

25.	GD 05525	Bush
26.	GT 20415	Latch - Cutter Clutch
27.	GT 02110	Blade Bolt Set
28.	GT 02138	Blade Set
29.	GT 02139	Blade and Bolt Set
30.	GT 20285	Disc and Spindle
31.	GT 08205	Bearing Protector
32.	GT 20177	Keyed Washer
33.	GT 00539	Shim
34.	GT 13815	Spindle Housing Complete
35.	GT 14044	Pulley
36.	GT 20019	Key
37.	GT 14390	Tab Washer
38.	GT 02003	Nut M20 L.H.
39.	GT 18005	V-Belt Cutters
40.	GT 07115	R.H. Bracket
41.	GT 07114	L.H. Bracket
42.	GT 01760	Nylon Button
43.	GT 12346	L.H. Lifting Chain
44.	GT 18975	R.H. Lifting Chain
45.	GT 02263	Jockey Wheel
46.	GT 20166	Bracket
47.	GT 05056	Tab - Spring
48.	GT 21004	Spring - Tension

*GT 20916 Cutter Deck Unit. This unit consists of all items shown on this sheet with the exception of items # 39, 40, 41, and 42 assembled and bolted onto the cutter deck and includes cutter clutch items shown on page 21.

PARTS AND SPECIFICATIONS SUBJECT TO CHANGE WITHOUT NOTICE.
STANDARD HARDWARE ITEMS ARE NOT SHOWN.

Body Work and Seat

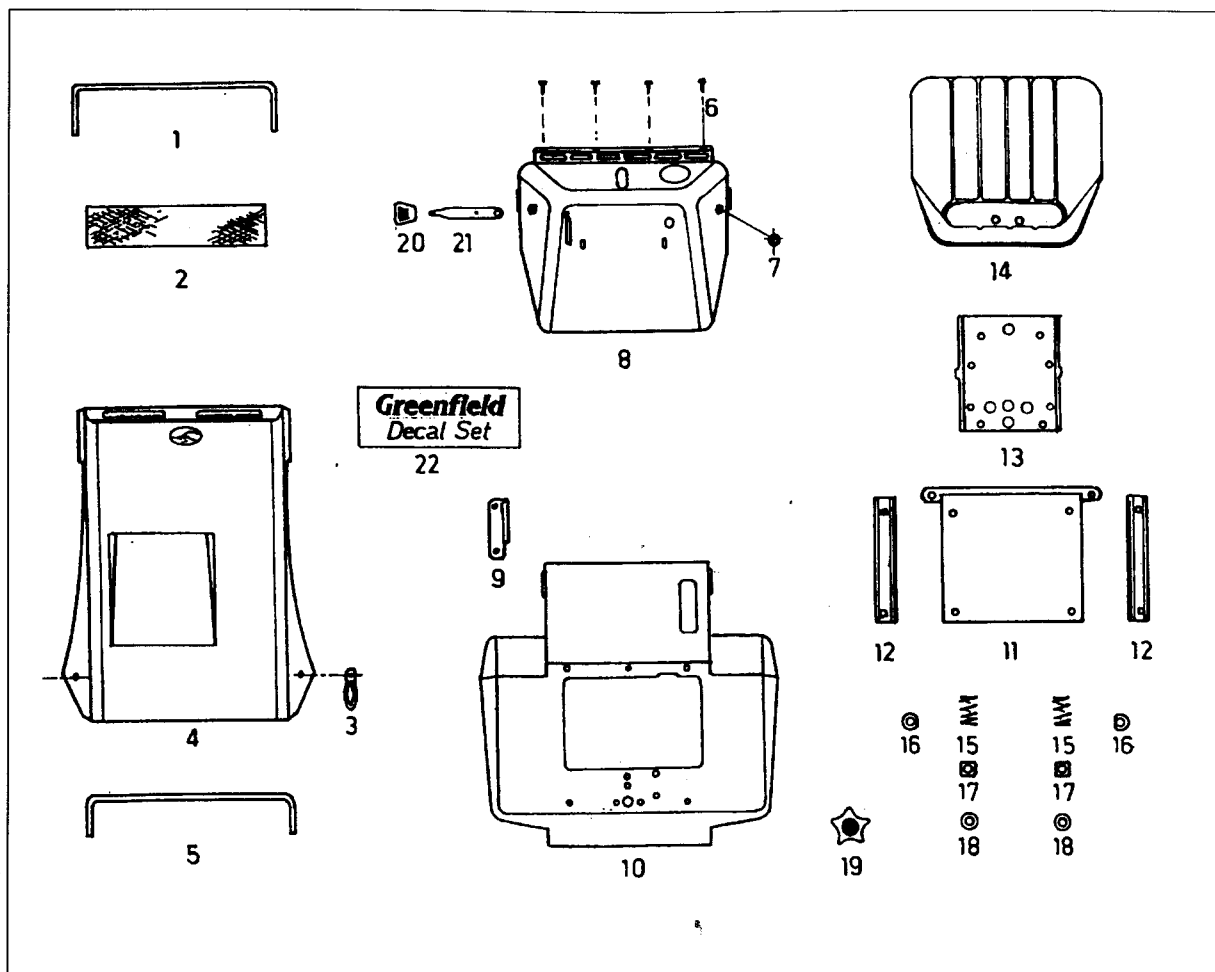

INDEX PART NO. DESCRIPTION

1.	GT 20160	Pinchweld Front
2.	GT 20155	Grille
3.	GT 07015	Strap - Bonnet Hold Down
4.	GT 20460	Bonnet
5.	GT 20161	Pinchweld Rear
6.	GT 06094	Buffer Grommet
7.	GT 02254	Bobbin - Strap
8.	GT 20450	Steering Cowl
9.	GT 18336	Latch - Park Brake
10.	GT 18670	Rear Cover
11.	GT 21340	Hinged Seat base
12.	GT 21343	Runner

INDEX PART NO. DESCRIPTION

13.	GT 21342	Seat Support
14.	GT 08064	Seat
15.	GT 14050	Spring
16.	GT 10452	Clamp
17.	GT 10451	Locating Block
18.	GT 01660	Washer
19.	GD 05545	Knob - Rear Cover
20.	GT 02025	Knob - Throttle Lever
21.	GT 20169	Throttle Lever
22.	GT 20037	Decal Set - B & S 17-34
23.	GT 20038	Decal Set - Honda 13-34

NOTE: BODY PANELS ARE BARE ITEMS PAINTED.

PARTS AND SPECIFICATIONS SUBJECT TO CHANGE WITHOUT NOTICE.

STANDARD HARDWARE ITEMS ARE NOT SHOWN.

GUARANTEE

Greenfield Mowers Pty Ltd the manufacturer guarantee their product free of faulty workmanship and material for a period of 12 months for domestic use, 3 months for commercial use. Engines and batteries used on Greenfield mowers carry the respective manufacturers warranty.

For details of the special Greenfield 3 year extended warranty plan ask your Greenfield Dealer.

This guarantee will not apply to:

- Fair wear and tear, V Belts, Tyres, Tubes, Blades and Blade Bolts, blade holder, and damage caused by misuse, neglect and accidents.
- Repairs rendered necessary or arising from use of other than genuine Greenfield parts, or the relevant genuine engine manufactures parts.
- Any work performed by other than an authorised Greenfield dealer, or damages arising therefrom or parts that have been tampered with or dismantled.

Products or parts considered faulty should be returned intact to the authorised Greenfield dealer, or direct to Greenfield with all necessary information, freight paid for inspection. In all warranty claims the manufacturers decision is final and binding.

The benefits conferred by the above guarantee are in addition to all other rights and remedies in respect of the product which the consumer has under existing laws in Australia and New Zealand.

Greenfield Mowers Pty Ltd, the manufacturer reserves the right to change parts and specifications without notice.

Guarantee Registration Details

Owner _____

Address _____

_____ Postcode _____

Purchase Date _____ Model _____

Chassis No. _____ Engine No. _____

Dealer Name _____

Dealer Signature _____

Please complete this record which should be held by the purchaser and presented should service under guarantee be required. To register your guarantee please complete the enclosed guarantee card and return to Greenfield Mowers.

Greenfield
Mowers Pty Ltd

172 Ingram Road, Acacia Ridge, QLD 4110

PO Box 155 Archerfield QLD 4108

Fax: (07) 3344 1161. Tel: (07) 3345 6100

Web Site: www.greenfield.com.au Email: greenfld@gil.com.au