

SP108

# Greenfield

## OWNER'S MANUAL

### INSTRUCTIONS AND SPARE PARTS



---

#### EVOLUTION 2000

Models:	Briggs & Stratton .....	14 OHV 32
	Honda .....	13 OHV 32

---

**Greenfield** Products Pty Ltd

172 Ingram Road, Acacia Ridge, Qld, Australia 4110. Fax: (07) 3344 1161. Phone: (07) 3345 6100

E V O L U T I O N 2 0 0 0

# Contents

<b>Safety Instructions</b>		2
<b>Operating Instructions</b>		4
<b>Differential Instructions</b>		6
<b>Maintenance</b>	General	7
<b>Maintenance</b>	Blades and Belts	8
<b>Maintenance</b>	Chains, Steering and Parking Brake	12
<b>Electrical Circuits</b>		15
<b>Spare Parts</b>	Chassis	16
	Linkages	17
	Engine and Electrics	18
	Drive Clutch and Rear Axle	19
	Steering and Front Axle	20
	Cutter Deck 32"	21
	Body Work and Seat	22
<b>Service Record</b>		23
<b>Guarantee</b>		24
<b>Other Greenfield Products</b>		25



**Greenfield** 

**Australian Made Since 1966**

**© Greenfield Products Pty Ltd**

All details are correct at the time of printing but are subject to change without notice.

E  
V  
O  
L  
U  
T  
I  
O  
N  
2  
0  
0  
0

## Evolution 2000

Thank you for buying an Australian made **Greenfield** tractor mower. Follow the manufacturer's operating and maintenance instructions and many years of excellent trouble free service can be expected.

**Before operating** the mower **read the owner's manual carefully**. Do not allow children or any person unfamiliar with the safe operating procedure to operate this mower. Your Greenfield mower has been designed to meet stringent safety standards - but we remind you that a mower is a cutting device - **used incorrectly it could cause personal injury**.

## Safety Instructions

1. Do not carry passengers.
2. Know your controls. Read the operating instructions carefully. Learn how to stop the mower and the engine quickly in an emergency.
3. Do not mow whilst people, especially children or pets are in the mowing area.
4. Make sure the area to be mown is clear of sticks, stones, bottles, bones, wire and other debris which could be thrown by the blades.
5. Do not operate the machine without first inspecting the blades, blade bolts and blade holder for wear or damage. **Damaged blades and worn bolts are major hazards**. Always replace blades and blade bolts in sets to preserve balance. Replace worn or damaged parts with **genuine Greenfield** replacement parts only. N.B. Use of inferior, non-genuine service parts on your Greenfield mower could result in costly damage and even personal injury. Refer "Maintenance Instructions", for replacement part numbers and fitting instructions.
6. Before using, check that the grass catcher, safety switches and guards provided by the manufacturer are operating properly and fitted securely. Regularly check all the components on the mower to ensure the machine is in a safe operating condition.
7. Never mow while barefoot or wearing open sandals or thongs. Wear long trousers and heavy shoes. It is also important that you wear suitable eye protection.
8. A mower operator should be in good physical and mental health and not under the influence of any drug or alcohol which might impair vision, co-ordination or judgement.
9. Replace worn or faulty exhaust mufflers.
10. Keep the engine free of grass, leaves or excessive grease. These can be a fire hazard.
11. Refuel outdoors only. Do not smoke while fuelling engine. Never remove the cap of the fuel tank or add petrol while the engine is running or if the engine is hot, allow it to cool. Remove fuel cap slowly to relieve any tank pressure. If petrol is spilled do not attempt to start the engine but move the machine away from the area of the spill and avoid creating any source of ignition until petrol vapours have dissipated.
12. Check for fuel leaks, while refuelling or using the mower. If a fuel leak is detected, do not start the engine until the fuel leak is fixed and the spilled fuel is wiped away.
13. Do not operate the engine in a confined space where poisonous exhaust fumes (carbon monoxide) can collect.
14. Always disengage the cutting blades from the operator's seat before starting or stopping the engine.

15. Always mount the mower from the opposite side to the discharge chute.
16. Exercise extreme caution when on slopes. Reduce speed particularly when making sharp turns to prevent overturning or loss of control. Do not stop or start suddenly when mowing uphill or downhill.
17. Never operate a ride-on mower across a slope steeper than what you would comfortably drive a car across.
18. Stay alert for holes in the terrain and other hidden hazards.
19. Before crossing paths, driveways or any other area foreign to mowers, reduce engine speed, disengage cutting blades and lift cutting attachment to maximum height.
20. Watch out for traffic when crossing or operating the mower near roadways. Always mow with the grass deflector properly fitted.
21. When mowing, never direct discharge of material toward bystanders nor allow anyone near the machine while in operation.
22. Before leaving the operator's position -
  - (a) Disengage the cutting blades.
  - (b) Apply the parking brake.
  - (c) Stop the engine and remove the key.
23. Disengage the drive to the cutting blades and stop the engine -
  - (a) Before refuelling
  - (b) Before removing grass catcher or any attachment.
  - (c) Before making a height adjustment unless adjustment is being made from the operator's position.
  - (d) Before clearing blockages.
  - (e) Before inspecting, cleaning or working on the mower.
  - (f) After striking a foreign object (inspect the mower for damage and make necessary repairs before restarting and operating the machine).
  - (g) If the machine starts to vibrate abnormally (check immediately)
24. Disengage drive to the cutting blades when not in use or in transporting.
25. Do not over-speed the engine or alter governor settings. Excessive speed is dangerous and shortens the mower's life.
26. Use care when pulling loads or using attachments.
  - (a) Use only the approved drawbar hitch point.
  - (b) Limit loads to those you can safely control.
  - (c) Do not turn sharply. Use care when backing up.
27. Store the mower in a well ventilated room away from naked flames such as may be found in some hot water heaters.
28. Do not lend or sell the mower without the owner's manual.
29. **Warning** - Remove spark plug lead to avoid accidental starting before attempting any maintenance or inspection of the mower.

# Operating Instructions

## BEFORE STARTING

### Fuel

Top with clean regular **Unleaded** petrol only. Make sure the petrol is free from impurities, particularly water. The petrol tank is located inside the engine compartment of your Greenfield. Raise the bonnet for access. Do not use stale petrol in your mower, add clean fresh fuel for every mowing.

### Engine Oil

Fill to the Full mark indicated on the dipstick. Use SAE 30 SF oil. Don't overfill. Refer to "Crankcase Lubrication" in the maintenance section of this book.

### Tyres

Inflate to the pressure indicated on the tyres. Usually 20psi (140KPa) on the front and 10psi (70KPa) on the rear. Don't over inflate.

## TO START

Apply park brake, disengage blade clutch (Cutters Out). Turn on fuel tap (if fitted). For cold starting set throttle control to "Choke", Turn Starter Key or push starter button (whichever is fitted) ten (10) seconds, maximum to avoid overheating the starter motor. Make sure to return the key to the run position after the engine starts or each time you attempt to start it. If engine does not start it may be flooded. Set throttle half way then Turn Key Again. Do not allow children or any person unfamiliar with the safe operating procedure to use this mower. Know your controls. Read the following instructions carefully. Learn how to stop the mower and the engine quickly in an emergency.

**Important** - This Evolution Model Greenfield mower is fitted with a safety 'cut-out' switch activated by the seat. The operator must be seated to start the engine and remain seated while operating the mower. If you don't remain seated the engine will stop. This safety switch must be kept functional for your protection.

## TO OPERATE

A simple pivoted foot pedal controls forward, neutral and reverse. Toe pressure to move forward, heel pressure to move in reverse. Increased toe or heel pressure provides speed variation in forward or reverse respectively. Allow pedal to centralise for neutral. The drive pedal can also be used as a brake by applying toe or heel pressure opposite to the directional movement of the mower. Sudden or violent directional changes and/or wheel spinning must be avoided.

### Park Brake

The park brake lever is located in front of the right side rear mudguard, this lever has two positions, shift lever out and rearwards to engage the park brake. To disengage, shift lever out and forward. The spring loaded mechanism will self engage when mower is moved slightly forward or backwards. This brake can also be used for stopping the mower in an emergency. The park brake positively locks the rear axle and wheels for transport.

### Cutting Height

The height adjustment lever located to the right of the steering console enables the operator to select the desired cutting height. To alter the cutting height move the lever to the right then shift forward or backward to select the setting then release to lock in position. An indicator located in the step through panel displays the setting. Keep the indicator in the green band for maximum belt life.

### Blade Clutch

The blade clutch lever is located on the left side of the steering console. To engage the cutting blades push the lever down and across into the "**IN**" position. To disengage the cutting blades push the lever down slightly and to the left allowing the lever to return to the "**OUT**" position.

**Important** - For maximum belt life engage and disengage cutters with the cutter height indicator in the green band or mid height position and reduced engine speed.

### Seat

The operator's seat is adjustable front to rear. To adjust, hinge seat forward, loosen four seat securing bolts, slide seat to position required and retighten bolts.

## TO STOP

Reduce engine speed, disengage cutter blades (cutters out) apply park brake, allow engine to cool down by idling approximately 30 seconds. Set throttle control to "stop" position to switch engine off. Turn fuel tap off (if fitted).

# Greenfield Patented Differential

## Instructions and Hints

The Greenfield Evolution mower features a revolutionary new type of differential. This differential offers the operator the option of the full differential action of the rear wheels for improved steering and a tight turning circle, whilst eliminating rear wheel scuffing on fine lawns. Most people will run their Greenfield with the differential operating all the time. This is the preferred method of operation and is accomplished by keeping the handle hooked over the end of the rear axle (See "A" below).

**Important:** Do not attempt to engage or disengage the differential lock from the operator's seat or while the engine is running.

In some situations, such as extremely wet areas or for hill climbing, you may choose to lock the differential for improved traction. You accomplish this by releasing the handle from the end of the rear axle. The lock will automatically engage when released (See "B" below).

To return the differential to the operating position (see "A" below) turn the steering wheel either to the left or the right; then rock the mower back and forth while simultaneously pulling out on the engagement handle and hook it over the end of the rear axle.

If the left side rear wheel is removed, make sure the keyed engagement block slides freely into the engagement plate square before final tightening of the wheel nuts.

Greenfield differentials are lubricated and sealed for life at the factory. If in the unlikely event that your differential needs service, it must be returned to Greenfield intact. **Differentials that have been tampered with or dismantled will NOT be considered for warranty.** Normal warranty is 12 months for private use and 3 months for commercial use. Extended warranty is available for up to 3 years for private use or 6 months for commercial use. See your Greenfield dealer for details. Service and spares for the differential are only available through the factory.

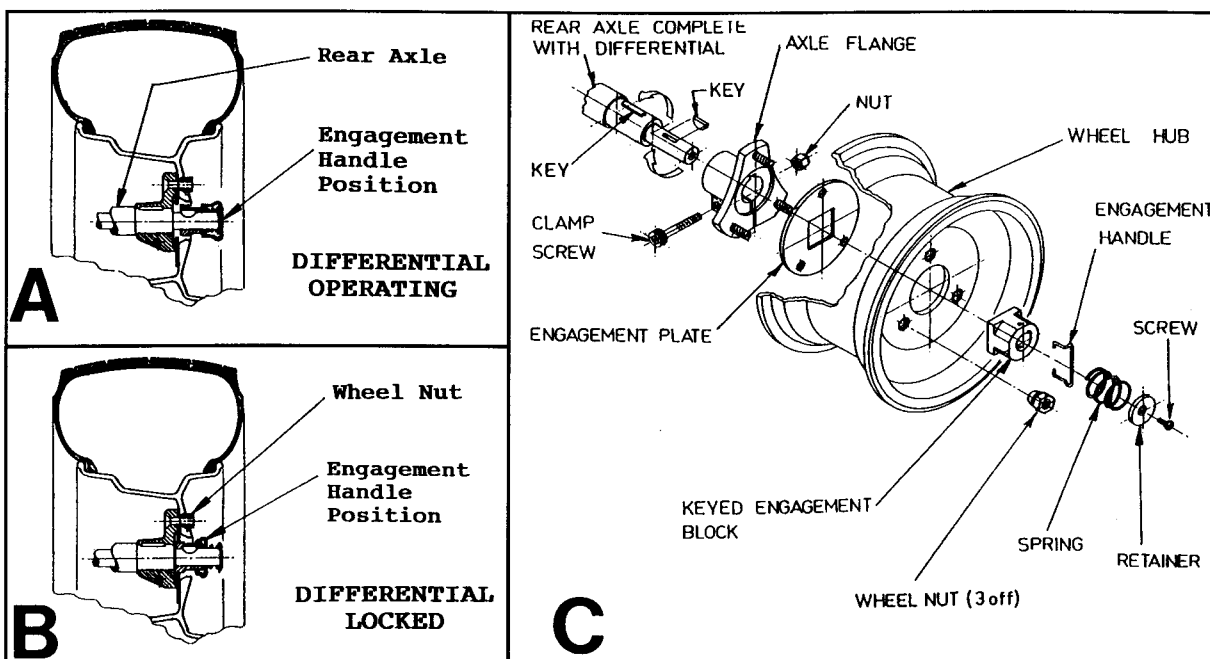

# Maintenance

**Warning:** Remove the spark plug lead to avoid accidental starting BEFORE attempting any maintenance or inspection of the mower.

## Crankcase Lubrication

Change engine oil after the first 5 hours of operation then every 6 months or 25 working hours, whichever comes first. Change more often in heavy work or dusty conditions. Drain engine oil whilst engine is warm then replace with a quality S.A.E. 30 S.F. motor oil (refer to the Engine Manufacturers Operating booklet oil recommendations). Fill to the full mark indicated on the dipstick. Don't overfill. To check oil level, position the mower on level ground, remove dipstick and wipe clean. Replace dipstick screwing correctly into position. Remove again and sight oil level. Dipstick must be firmly in place when engine is running.

## Air Filter

Service air filter as per the engine manufacturers booklet. Clean or replace more often in dusty conditions. Never operate the engine without the air filter correctly and securely fitted – rapid and expensive wear can occur.

## Cooling System

Remove the blower housing and clean out the grass and debris to prevent engine overheating. Refer to engine manufacturer's booklet.

## Battery

Top with distilled water to the correct level as required. If externally charging, care is needed. TRICKLE CHARGE ONLY to avoid battery damage.

**Warning:** Do not let the battery discharge during winter, trickle charge regularly, at least once a month.

## Wheels

The rear wheel nuts should be re-tensioned after the first 5 hours of operation to 16Nm (12 ft.lbs), then regularly with your preventative maintenance checks.

## Tyres

Inflate to pressure indicated on the tyres. Usually 20psi (140KPa) on the front and 10psi (70KPa) on the rear.

## Cleaning

Never wash your Greenfield with a high pressure washgun. You could blast water and dirt past the seals in the bearings and cause premature bearing failures and rusted pivot points.

- Never wash your Greenfield right after you use it. The quenching contraction effect from hosing off the machine when it's at operating temperature could also draw water and dirt into the bearings and cause premature bearing failures.
- The best way to clean your Greenfield is to use an air hose to blow the loose grass, etc. from around pulleys, belts and the top of the cutter deck. Wash the exterior with a sponge and bucket, then rinse off with a hose and wipe it down the same as you would your car. For maximum machine life, do not spray water on the pulleys and bearings.
- Clear off all grass and other debris from your Greenfield each time before you use it. Sticks, stones or an accumulation of grass and other debris will damage belts and fracture pulleys if they go through between the pulley and belt.



## BLADES AND BELTS

### Belts

Greenfield "V" belts are self adjusting but cutter belts may need occasional adjustment within their tensioning range (see page 11). Inspect the "V" belts regularly and replace if damaged. Part Numbers for V belts are -

Drive V Belt GT14004

Cutters V Belt GT14003

**Important** - For long service life, **use only genuine Greenfield branded V belts**, refuse substitutes.

### Blades

Check condition of blades, blade bolts and blade holder. Replace if damaged or worn. Worn or damaged blades and bolts are major hazards. Always replace worn or damaged blades and bolts in sets to preserve balance. **Use only Genuine Greenfield branded replacement parts.** Use of inferior non-genuine replacement parts on your Greenfield could result in costly damage or even personal injury. Part Numbers for Blades and Bolts are:

Cutter Blade and Bolt Set GT2139

To fit new blades refer to Illustration A.

Tighten the blade bolt nuts firmly. Correct torque is 44Nm. (32ft. lbs). Blades must be free to turn but not loose. Lightly oil the blade pivot point before fitting.

**Illustration A**



### Chassis Lubrication

Your Evolution 2000 Greenfield mower has 6 greasing points (refer Illustration B).

1. Grease every 6 months or 50 hours. Grease nipples are fitted to the king pin housings in the front axle beam.
2. A grease nipple is fitted to the steering pivot assembly GT14660 accessible from under the chassis adjacent to the drive control pedal.
3. A grease nipple is fitted to the steering tube located inside the steering console.
4. Grease nipples are also fitted to the front and rear lifting shafts which raise and lower the cutting deck.

Grease these locations with a quality No. 2 lithium base grease or equivalent. It is recommended your grease gun be fitted with a flexible hose. All other exposed pivoting joints, lever points and slides are to be lubricated with engine oil. The rear drive chain should be removed, thoroughly cleaned in kerosene and reoiled with a quality chain oil every 50 hours, more often if hosed.

**Illustration B - Evolution 2000 - Grease Points**

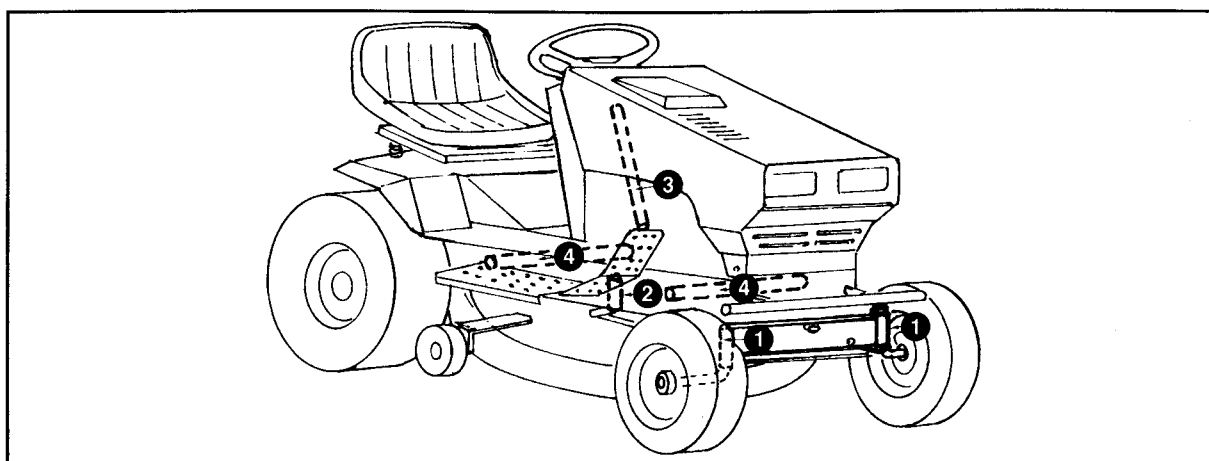

## To Remove Rear Drive Belt

1. Remove the spark plug lead to prevent accidental starting.
2. Lift up the seat and disconnect the wire to the seat cut out switch by pulling apart the spade connector on the blue wire by the top of the battery. Remove the rear cover by undoing the star knob under the seat and removing the rear cover and seat assembly.
3. Set the blade height to the **"LOW"** position.
4. Swing back the steady bracket supporting the rear clutch link (refer Illustration C).
5. Remove the retaining pin from the back end of the clutch yoke. Lift off the rear clutch link and swing rearward (refer Illustration D).
6. With the spring release hook tool provided (see Illustration E), remove the tension spring from the idler pulley notch bar.
7. Release the notch bar leaf spring by inserting the hook tool between the leaf spring and the notch bar. Rotate the hook tool and hold the leaf spring in a released position allowing the idler pulley to slide freely rearwards to permit belt removal (refer Illustration E).
8. Remove the belt from the pulleys and remove through the opening at the rear clutch link.

**Illustration C**

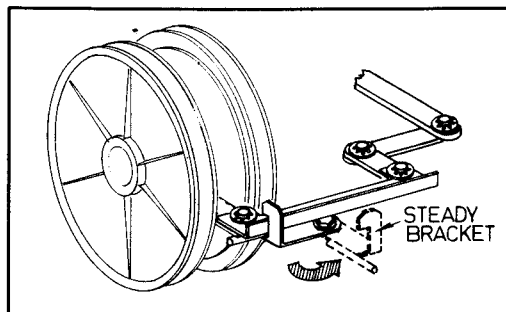

**Illustration D**

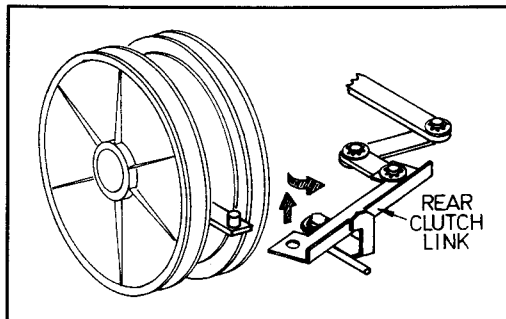

**Illustration E**

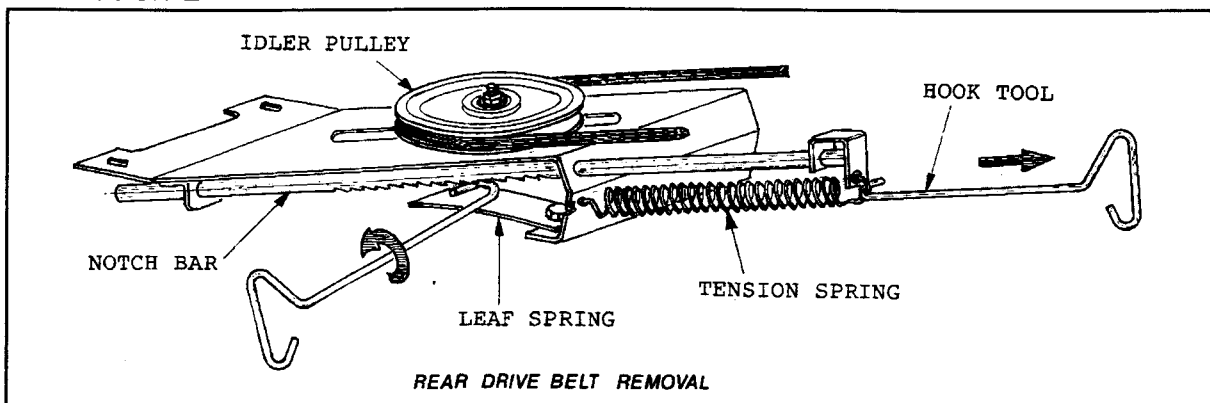

## To Replace Rear Drive V Belt

1. Feed the belt down the back of the clutch pulleys around the flat and "V" alignment pulleys and into the bottom groove on the engine pulley.
2. Fit the belt into both clutch pulleys then into the idler pulley on the notch bar. This pulley will need to be in the fully rearward position.
3. Re-fit the notch bar tension spring using the hook tool. The idler pulley will slide forward and tension the belt.
4. Replace the rear clutch link and retaining pin.
5. Swing the steady bracket forward to support the rear clutch link.
6. Replace the rear cover and reconnect the wire to the seat safety cut out switch.
7. Replace spark plug lead.

## To Remove Cutter V Belt

1. Remove the spark plug lead to prevent accidental starting.
2. Make sure the cutter clutch is disengaged.
3. To remove the cutter V belt the drive belt must first be removed from the engine pulley. Follow step Nos. 2, 3, 6, and 7 of "To Remove Drive Belt" instructions (page 9).
4. Remove the V belt from the engine pulley by manoeuvring the belt down between the pulley and the V belt guide pins.
5. Remove the fixed clutch pulley and belt guide from the right side plus the sliding clutch pulley and belt guide from the left side under the main frame behind the front axle (see Illustration F).
6. Remove the belt guard from the cutter deck pulley. Remove the belt from the machine.

### Illustration F

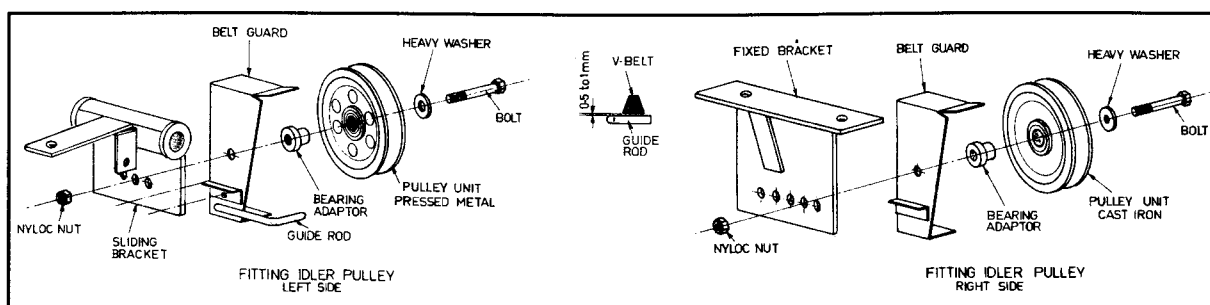

## To Replace Cutter V Belt

1. Slide the V belt over the front cutter deck lifting shaft and into the top groove of the engine pulley ensuring the belt is inside belt guide pins.

**Note** - The drive V belt must first be removed to enable the cutter belt to be fitted to the engine pulley. To remove the drive belt from the engine pulley follow steps 1, 2, 3, 6, and 7 of "To Remove Drive Belt" instructions (page 9).

2. Refit the idler pulleys into the mounting brackets in the following order (refer Illustration F) - slip the heavy washer onto the bolt, then insert the bolt into the pulley. The bearing adaptor then slips on the bolt and into the bearing in the pulley. Hold the belt in the V groove while the belt guard is slipped over the bolt with the wings of the guard over the belt and pulley at top and bottom. This assembly is then fitted to the sliding bracket. Push the bolt through the predetermined hole. Refer "Cutter Belt Adjustment" then fit the nyloc nut and tighten with two spanners.

**Important** - Check that pulleys turn freely inside belt guards with belt disengaged.

**Note** - The heavy cast iron pulley is fitted into the fixed bracket on the right side of the machine as viewed from the drivers seat.

3. Fit the belt into the cutter deck pulley and refit the belt guard around the cutter deck pulley.
4. Refit the drive V belt to engine pulley, refer "To Replace Drive V Belt" instructions.
5. Replace the spark plug lead. From the operator's seat, run engine and engage cutters to check V belt operation. (refer cutter belt adjustment page 11).

**Note** - A belt run-in period is required as follows. With the height adjusting lever in the green band (mid height position) engage cutter blades and run for a minimum of ten minutes at medium engine speed. Ideally, a total run-in time would be approximately one hour, during which time you can cut grass, on a mid height position.

## Cutter Belt Adjustment

**Warning:** Remove the spark plug lead to avoid accidental starting **BEFORE** attempting any maintenance or inspection of the mower.

With the cutter clutch lever in the "**OUT**" position (disengaged) the cutter belt should be sufficiently disengaged to allow the cutter blades to come to a complete stop in approximately 7 seconds. The correct amount of belt slack and the efficient operation of the cutter brake control this stopping time. The spring loaded clutch idler pulley maintains the correct belt tension when the blade clutch lever is in the "In" position.

Both cutter belt idler pulleys can be adjusted to allow for belt stretch. The first adjustment should be checked after approximately 5 hours of operation with further checks after approximately 50 hours. Adjust if necessary.

The right side pulley has 5 positions available when a new belt is fitted. This pulley should be fitted in the second hole from the rear, or, if some wear to the pulleys is evident or extraordinary belt stretch is experienced then fit the pulley to the next hole forward. When fitted check to see that the pulley turns freely with the cutter clutch in the "**OUT**" position.

The left side pulley sliding bracket has 3 adjustment holes. The guide rod clearance is factory set for the centre hole. Should this pulley be moved to a new position the clearance between the underside of the cutter V belt and the guide rod attached to the belt guard would need to be reset as follows -

- (a) Remove spark plug lead to avoid accidental starting.
- (b) Lower cutter deck to lowest position.
- (c) Engage cutter clutch "**IN**" position.
- (d) Position guard to give air gap of 0.5 to 1mm between belt and guide rod. Refer to centre of Diagram F.

The cutter belt has an adjustment indicator decal on the front left side of the chassis. When the cutter clutch is engaged and the pointer has travelled fully into the red zone an adjustment to the position of the idler pulley is required. Remove the right hand pulley and move it forward one hole to adjust.

The manufacturer recommends all Greenfields be returned to your authorised Greenfield dealer for normal servicing i.e. oil changes, air filters etc. at the times indicated in the maintenance section and by the engine manufacturer. The manufacturer also recommends a maintenance and safety inspection be performed every 6 months or every 50 working hours by your authorised Greenfield dealer to comply with the conditions for both standard and extended warranty offered by the manufacturer, refer to the warranty leaflet.

## CHAINS AND BRAKES

### Steering Chain Adjustment

1. Remove the spark plug lead to prevent accidental starting.
2. Lift up the seat and disconnect the wire to the seat cut out switch by pulling apart the spade connector on the blue wire by the top of the battery. Remove the rear cover by undoing the star knob under the seat and removing the rear cover and seat assembly. Remove neg. (—) battery lead.  
**Note:** The steering wheel and cowl may not need to be removed or loosened on later model machines in order to remove the step through cover.
3. Remove steering wheel centre cap by pressing in the two retaining tabs located on the underside of the steering wheel on either side of the "Greenfield" name. Remove the steering wheel bolt, then remove the steering wheel and centre boss.
4. Remove the starter key by rotating it counter clockwise  $\frac{1}{2}$  turn and pull out.
5. Pull knob off throttle control.
6. Remove the two steering cowl bolts to allow the cowl to move.  
**Note:** Do not attempt to remove the cowl as the wiring is still connected.
7. Remove the two self tapping screws on the step through cover. Hold the cowl up slightly for clearance and remove the step through cover for access to the steering chain.
8. Refer to Illustration G and loosen the lower bolt on the chain adjusting arm and push the arm to the left to tighten the steering chain to a maximum of 3mm slack as shown in Illustration H. Do not overtighten.  
Re-tension the lower bolt on the chain adjusting arm.
9. Re-assemble in reverse order.
10. Always check steering stop adjustment after adjusting the steering chain because the chain adjustment can affect the stops.

Illustration G

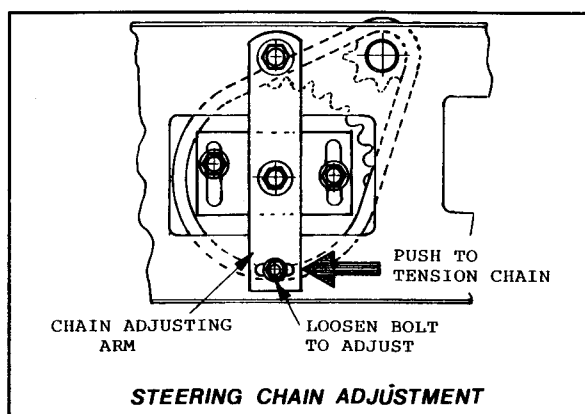
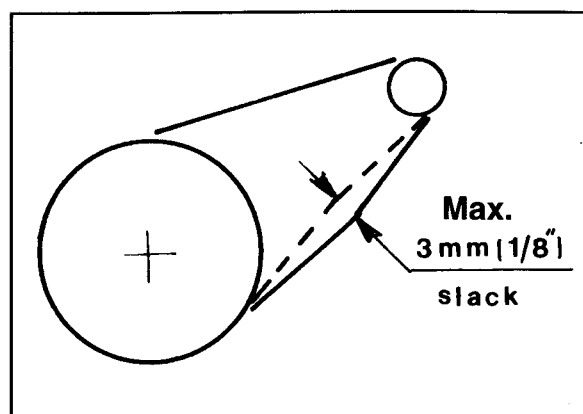

Illustration H



## Steering Stop Adjustment

1. Always perform your steering chain adjustment before you adjust the steering stops because the chain adjustment can affect the stops.
2. Follow steps 1 through 7 from steering chain adjustment procedure above.
3. Loosen all four stops, one on each king pin and two on the chain adjuster bracket (refer Illustration J, item A and B).
4. Turn the steering wheel full lock to the right till the front tyre is approximately 5mm from the machine. Rotate the eccentric stop "A" on the right hand king pin until it is hard against the axle beam then lock in this position.
5. Slide right side bolt stop "B" in chain adjuster bracket until bolt head hits against tie rod end securing nut "C" then move the bolt away to give a clearance of approximately  $\frac{1}{2}$  mm between bolt "B" and nut "C". If securing nut "C" will not hit bolt stop "B" you may have to adjust drag link or steering rod to give you more travel.
6. Turn the steering wheel full lock to the left then repeat steps 2 and 3 listed above.
7. To check your adjustments are correct turn steering wheel to either lock, noting stop "A" contacts momentarily before stop "B". This will ensure smallest turning circle without unnecessary strain on the steering components.

**Note** - Front wheels are set parallel to 1.5mm ( $\frac{1}{16}$ " ) toe-in.

Illustration J

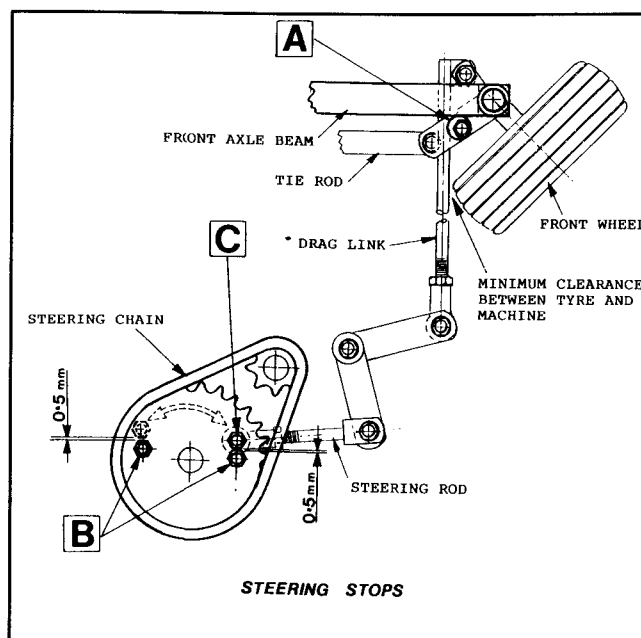

## Rear Drive Chain Adjustment

Illustration K

1. **Important:** Always check park brake adjustment after adjusting the drive chain because the chain adjustment affects the park brake adjustment.
2. Disconnect spark plug lead to prevent accidental starting.
3. Remove rear cover and seat assembly. (refer No. 2 - Steering Chain Adjustment).
4. Raise and block up rear of mower. Remove rear wheels for access to flange plates.
5. Loosen the four rear axle flange bearing mounting plates (2 on each side) (see Illustration K).
6. Adjust the chain by turning the adjusting nuts positioned below the rear axle side plates clockwise to tighten the chain. It is very important to adjust each side evenly so the rear axle remains parallel to the mower chassis and the sprockets are in alignment. It is suggested that you turn each nut no more than a quarter of a turn at a time alternating between the two until the chain has 3mm slack as shown in Illustration H. Do not overtighten.

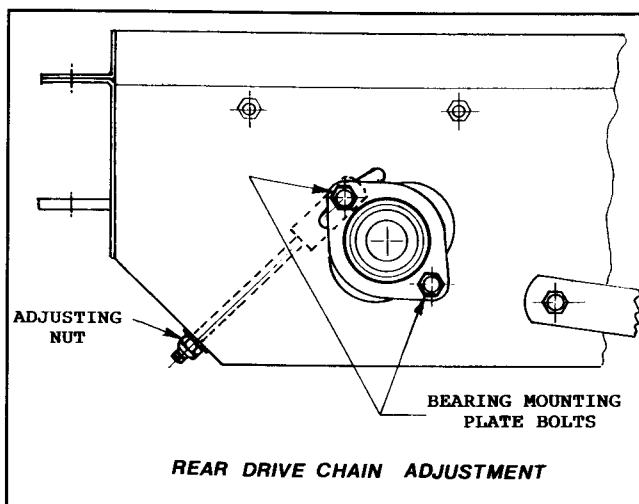

7. Re-tension rear axle flange bearing mounting plate bolts.
8. Re-fit and tension rear wheels to 16Nm (12ft.lbs.).
9. Re-fit rear cover and reconnect blue safety switch wire.

### Park Brake Adjustment

1. Always perform your drive chain adjustment before the park brake adjustment.
2. Check that the brake arm moves freely on the pivot bush by swinging the arm forward against the spring. Lubricate if necessary.
3. Check clearance between the brake arm and the brake disc in the "Off" position is approximately 3mm (refer Illustration L). Adjust with nut as shown.
4. With the brake lever in the "On" position check the brake arm lug fully engages into the recess in the brake disc.
5. Refit spark plug lead.

Illustration L

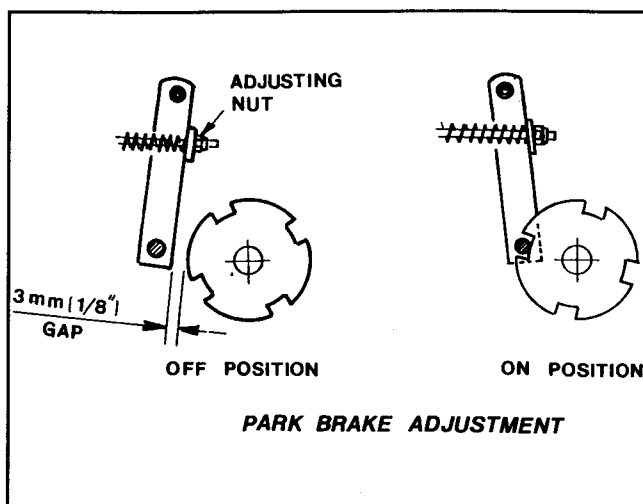

# Electrical Circuits

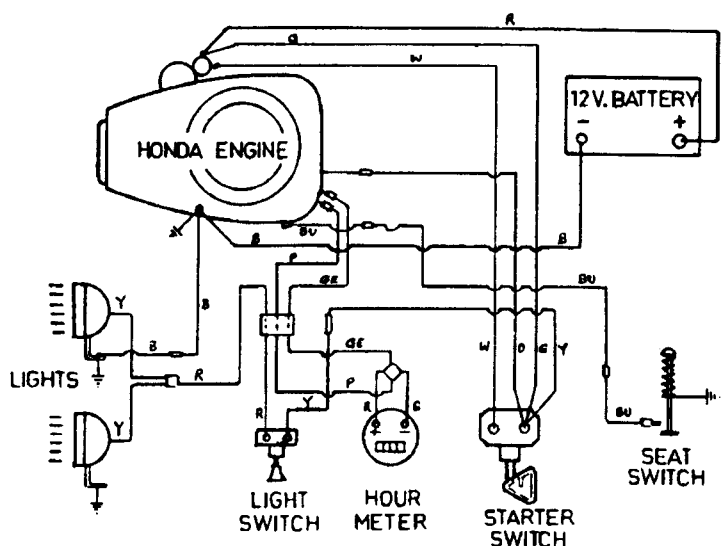
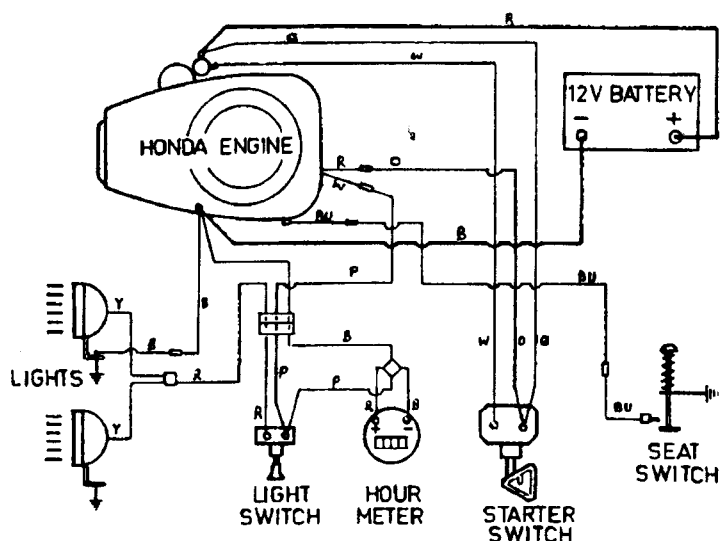
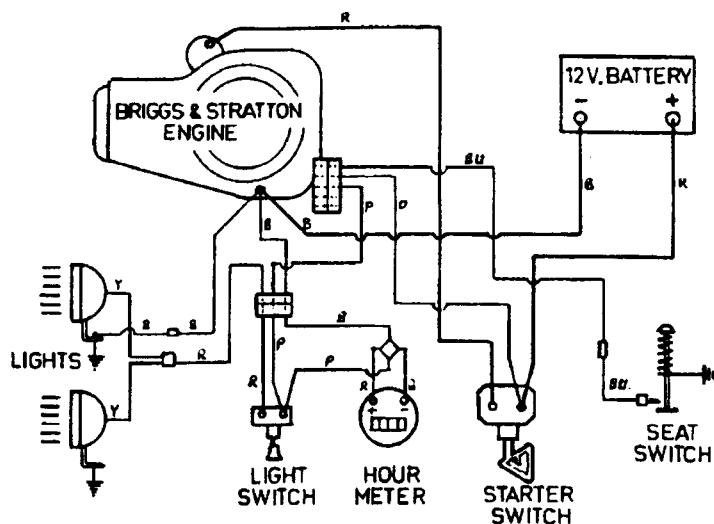

## COLOUR LEGEND

B	BLACK
G	GRAY
O	ORANGE
P	PURPLE
R	RED
W	WHITE
Y	YELLOW
BU	BLUE
GE	GREEN



## Chassis

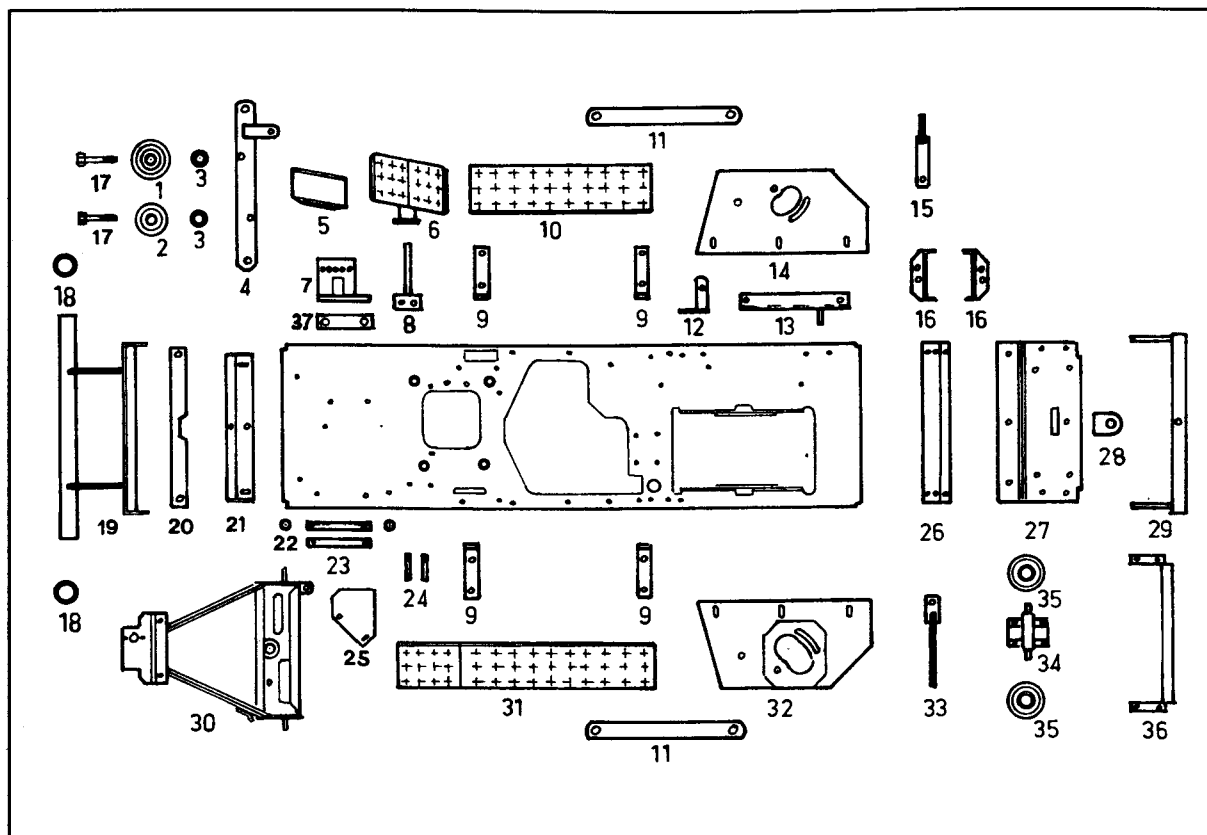

INDEX	PART NO.	DESCRIPTION	INDEX	PART NO.	DESCRIPTION
1	GT 6171	Flat Idler Pulley & Bearing	19	GT 14620	Front Bumper and Plate
2	GT 14002	"V" Idler Pulley & Bearing	20	GT 10524	Backing Strip
3	GT 329	Bearing Adaptor	21	GT 14301	Bonnet Mounting Plate
4	GT 14780	Support Bracket	22	GT 730	Spacer
5	GT 14337	Heat Shield	23	GT 14318	Slide Bar - Cutter Clutch
6	GT 14680	F-R Foot Pedal	24	GT 14012	Belt Guide Pin
7	GT 14970	Fixed Pulley Bracket	25	GT 12336	Heat Shield
8	GT 14875	F-R Pedal Shaft	26	GT 14304	Brace
9	GT 12376	Support Running Board	27	GT 14790	Rear Panel
10	GT 12369	R.H. Running Board	28	GT 12338	Tow Bar Lug
11	GT 14303	Link Bar 32" Model only	29	GT 14705	Support Rear Cover
12	GT 14316	Support - Wiring Harness	30	GT 14810	Steering Frame
13	GT 14675	Support Brace - Brake Arm	31	GT 13640	L.H. Running Board
14	GT 14690	R.H. Side Plate	32	GT 14710	L.H. Side Plate
15	GT 14730	R.H. Chain Adjuster	33	GT 14720	L.H. Chain Adjuster
16	GT 14310	Battery Bracket	34	GT 7555	Idler Pulley Bracket
17	GT 1093	Bolt	35	GT 1009	Flat Idler Pulley & Bearing
18	GT 6081	Plastic Bumper Cap	36	GT 14740	Side Plate Support 32" Model only
			37	GT 14348	Reinforcing Plate

PARTS AND SPECIFICATIONS SUBJECT TO CHANGE WITHOUT NOTICE.

STANDARD HARDWARE ITEMS ARE NOT SHOWN

# Linkages

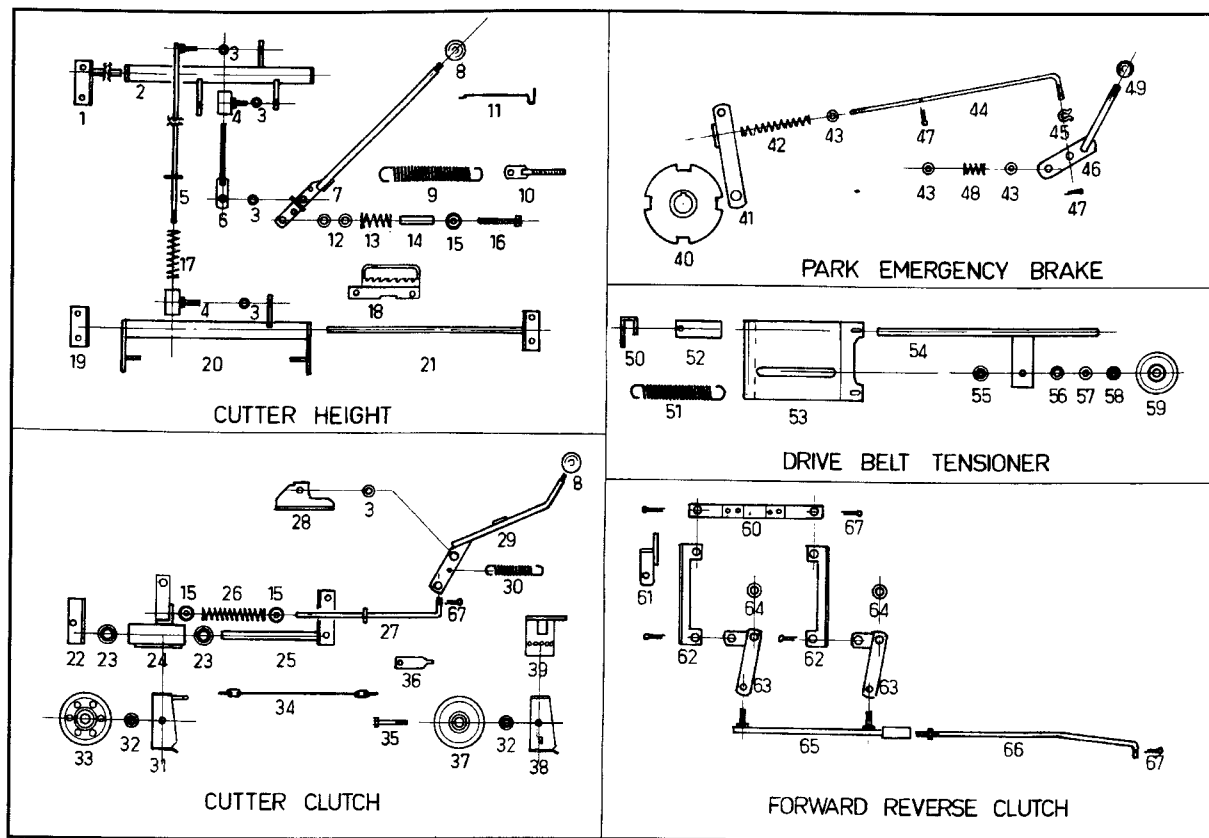

INDEX	PART NO.	DESCRIPTION	INDEX	PART NO.	DESCRIPTION
1	GT 14845	Pivot Rod Front	35	GT 1093	Bolt
2	GT 14850	Height Adjust Tube Front	36	GT 14321	Belt Stretch Indicator
3	GT 730	Pivot Bush	37	GT 6868	V Pulley and Bearing (Cast Iron)
4	GT 14785	Sliding Bush	38	GT 14880	R.H. Belt Guide
5	GT 14905	Tilt Adj. Link	39	GT 14970	Fixed Pulley Bracket
6	GT 14715	Height Adj. Link	40	GT 13250	Park Brake Disc
7	GT 14735	Height Adj. Handle	41	GT 13350	Brake Arm
8	GT 523	Knob	42	GT 12032	Spring
9	GT 6030	Spring	43	GT 1035	Washer
10	GT 12930	Tensioner	44	GT 14322	Brake Rod
11	GT 14319	Height Indicator	45	GT 144	Circlip
12	GT 23	Washer	46	GT 13220	Brake Lever
13	GT 349	Spring	47	GT 167	Split Pin
14	GT 14320	Sleeve	48	GT 1294	Spring
15	GT 585	Cup	49	GT 524	Knob
16	GT 1118	Bolt	50	GT 7308	Bracket
17	GT 6022	Spring	51	GT 1554	Spring
18	GT 15040	Height Adjust Rack	52	GT 14023	Leaf Spring
19	GT 14826	Bracket	53	GT 14820	Bracket
20	GT 14840	Height Adjust Tube Rear	54	GT 14830	Notch Bar
21	GT 14825	Pivot Rod Rear	55	GT 608	Slide Bush
22	GT 14317	Bracket	56	GT 23	Washer
23	GT 6056	Bronze Bush	57	GT 579	Wave Washer
24	GT 15020	Sliding Bracket	58	GT 610	Bearing Adaptor
25	GT 15030	Slide Rail	59	GT 7965	"V" Pulley and Bearing
26	GT 14024	Spring	60	GT 13833	Yoke Unit Complete
27	GT 14665	Clutch Rod	61	GT 14685	Steady Bracket
28	GT 14339	Bracket	62	GT 14309	Clutch Link
29	GT 15070	Clutch Handle	63	GT 14870	Pivot Arm
30	GT 6064	Spring	64	GT 10006	Pivot Bush
31	GT 14980	L.H. Belt Guide 32" Model only	65	GT 14645	Rod Assembly
32	GT 6018	Bearing Adaptor	66	GT 14311	Clutch Rod
33	GT 6901	V Pulley & Bearing	67	GT 165	Split Pin
34	GT 15801	Pull Linkage - Cutter Brake 32" model only			

PARTS AND SPECIFICATIONS SUBJECT TO CHANGE WITHOUT NOTICE.  
STANDARD HARDWARE ITEMS ARE NOT SHOWN

This diagram illustrates the components of a portable electronic device, likely a radio or a small television, shown in an exploded view. The parts are numbered 1 through 34. The main assembly is shown on the left, with a dashed box highlighting the area where part 34 (a speaker or grille) is attached. The other parts are shown separately, indicating their positions relative to the main unit. The parts include a speaker (34), a main housing (1), a circular component (2), a small rectangular component (3), a small square component (4), a small circular component (5), a small circular component (6), a small rectangular component (7), a long thin component (17), a small rectangular component (18), a small rectangular component (21), a small rectangular component (22), a small rectangular component (23), a small rectangular component (24), a small rectangular component (25), a small rectangular component (26), a small rectangular component (27), a small rectangular component (28), a small rectangular component (29), a small rectangular component (30), a small rectangular component (31), a small rectangular component (32), a small rectangular component (33), and a small rectangular component (34).

INDEX	PART NO.	DESCRIPTION	INDEX	PART NO.	DESCRIPTION
1	GT 14017	Spacer	18	GT 1252	Cable Clamp
2	GT 14016	Engine Pulley	19	GT 12353	Throttle Lever
3	GT 1500	Key	20	GT 2025	Throttle Knob
4	GT 520	Grub Screw	21	GT 14359	Bracket - Throttle Cable
5	GT 1750	Washer	22	GT 2215	Fuel Tap when fitted
6	GT 2021	Spring Washer	23	GT 14315	Battery Clamp
7	GT 1069	Bolt	24	GT 1914	Battery
8	GT 15050	Fuel Tank Support	25	GT 14336	Rubber Mat - Battery
9	GT 14323	Clamp Strap - Fuel Tank	26	GT 15816	Wiring Harness Honda
10 *	GT 15820	Fuel Tank Unit consists of items 11,12,13 & 14	26	GT 15808	Wiring Harness Briggs & Stratton
11	GT 14001	Fuel Tank	27	GT 1915	Starter Switch
12	GT 6031	Cap - Fuel Tank	28	GT 1997	Starter Key
13	GT 10043	Hose Tail	29	GT 12345	Insulator + Terminal
14	GT 10044	Nut	30	GT 6090	Light Switch
15	GT 14325	Fuel Hose Honda	31	GT 6084	Hour Meter
15	GT 14324	Fuel Hose Briggs & Stratton	32	GT 13831	Seat Safety Switch Unit
16	GT 2024	Hose Clamp	33	GT 6054	Headlight
17	GT 15817	Throttle Cable Honda	34	GT 15075	Heat Shield 14HP B&S only
17	GT 15810	Throttle Cable B & S			

STANDARD HARDWARE ITEMS ARE NOT SHOWN

# Drive Clutch & Rear Axle

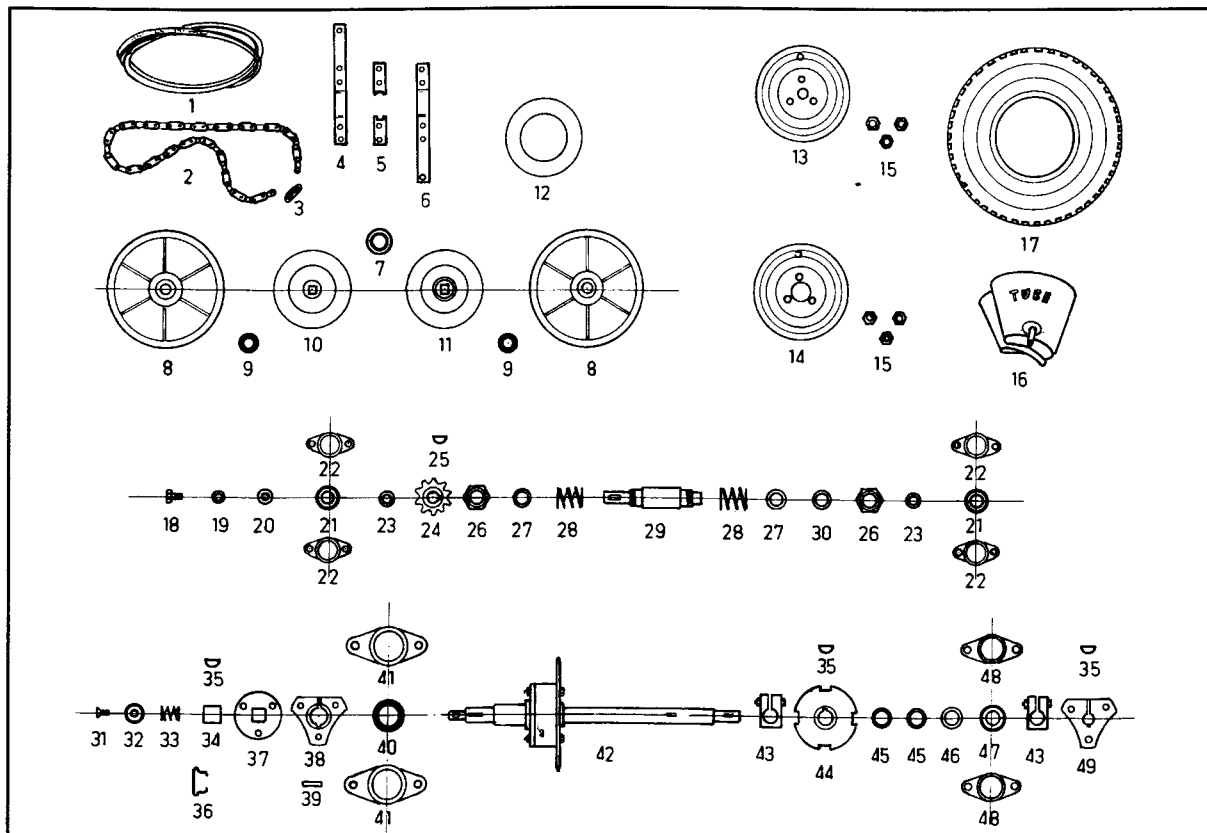

INDEX	PART NO.	DESCRIPTION	INDEX	PART NO.	DESCRIPTION
1	GT 14004	V Belt Drive	27	GT 7303	Washer
2	GT 12041	Roller Chain	28	GT 357	Spring
3	GT 501	Connecting Link	29	GT 14008	Square Drive Shaft
4	GT 10620	Yoke Top Half	30	GT 539	Shim when fitted
5	GT 12364	Retainer	31	GT 2425	Screw
6	GT 10630	Yoke Bottom Half	32	GT 10488	Spring Retainer
7	GT 855	Bearing	33	GT 2958	Spring
8	GT 920	Clutch Pulley Complete	34	GT 2956	Engagement Block
9	GT 2206	Bearing For Pulley	35	GT 516	Key
10	GT 6855	L.H. Drive Plate (Reverse)	36	GT 2957	Handle
11	GT 6856	R.H. Drive Plate (Forward)	37	GT 2955	Engagement Plate
12	GT 6012	Clutch Lining	38	GT 2954	Wheel Flange L.H.
13	GT 1624	Rear wheel Hub Right Side	39	GT 2995	Key
14	GT 2929	Rear Wheel Hub Left Side	40	GT 2209	Bearing
15	GT 2011	Wheel Nut	41	GT 2210	Flangette Plate
16	GT 1535	Tube	42		Rear Axle unit, return to factory for service
17	GT 1203	Tyre	43	GT 7032	Clamp
18	GT 1455	Set Screw	44	GT 13250	Brake Disc
19	GT 2052	Spring Washer	45	GT 7041	Spacer
20	GT 7306	Washer	46	GT 7413	Washer
21	GT 392	Bearing	47	GT 390	Bearing
22	GT 7017	Flangette Plate	48	GT 7083	Flangette Plate
23	GT 1488	Washer	49	GT 1625	Wheel Flange R.H.
24	GT 9027	10 Tooth Sprocket			
25	GT 517	Key			
26	GT 347	Nut			

PARTS AND SPECIFICATIONS SUBJECT TO CHANGE WITHOUT NOTICE.

STANDARD HARDWARE ITEMS ARE NOT SHOWN

# Steering & Front Axle

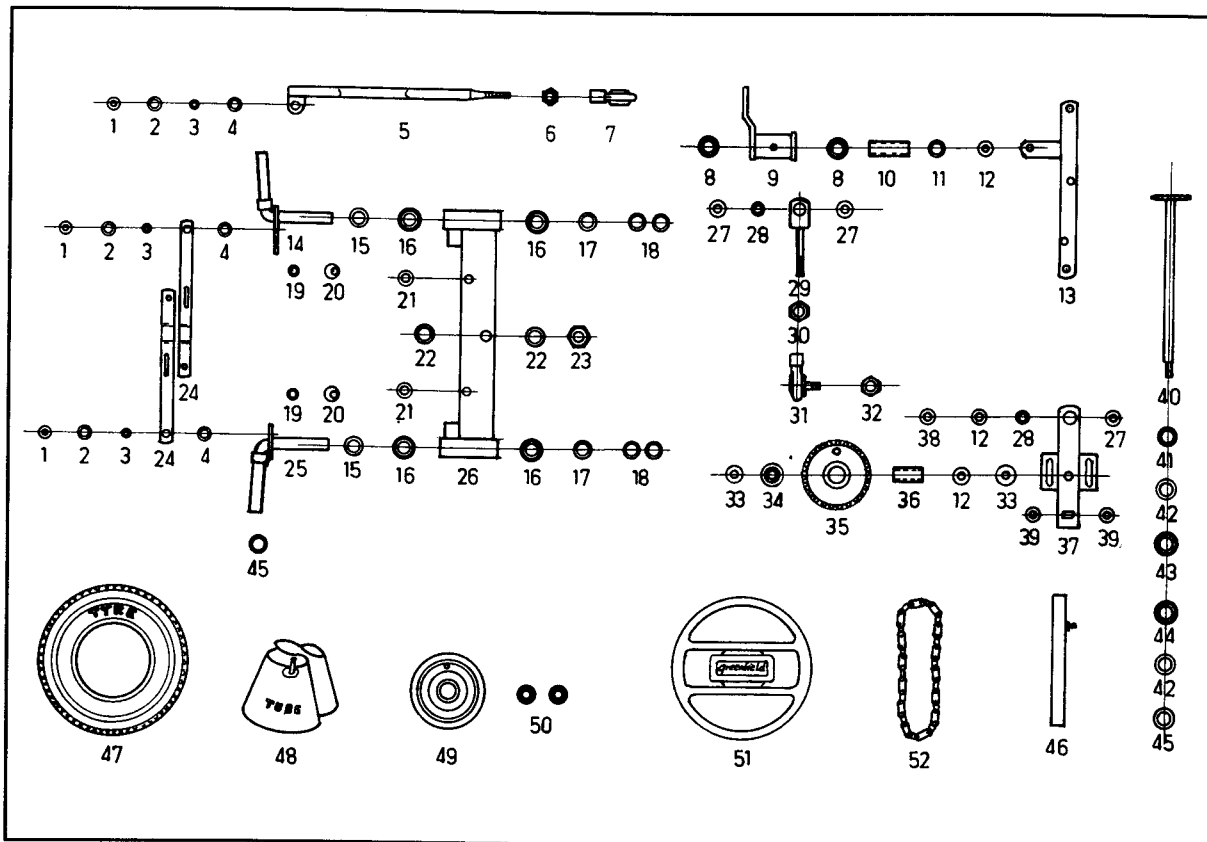

INDEX	PART NO.	DESCRIPTION	INDEX	PART NO.	DESCRIPTION
1	GT 10488	Cup	27	GT 1012	Washer
2	GT 534	Felt Seal	28	GT 730	Pivot Bush
3	GT 10037	Pivot Bush	29	GT 14670	Steering Rod
4	GT 10038	Nylon Washer	30	GT 2406	Nut
5	GT 14650	Drag Link	31	GT 6044	Tie Rod End
6	GT 78	Nut	32	GT 2090	Nyloc Nut
7	GT 1626	Tie Rod End	33	GT 1025	Washer
8	GD 5525	Bush	34	GT 6056	Bush
9	GT 14660	Steering Link	35	GT 13740	Chain Wheel
10	GT 14006	Sleeve	36	GT 10024	Sleeve
11	GT 23	Washer	37	GT 13320	Chain Adjusting Arm
12	GT 579	Wave Washer	38	GT 9407	Washer
13	GT 14780	Support Bracket	39	GT 7306	Washer
14	GT 14640	R.H. King Pin	40	GT 13140	Steering Shaft
15	GT 2018	Washer	41	GT 12029	Spacer
16	GT 1766	Bush	42	GT 7304	Washer
17	GT 2014	Washer	43	GT 6056	Bush Bronze
18	GT 580	Retainer	44	GT 1766	Bush Nylon
19	GT 14302	Spacer	45	GT 7009	Collar
20	GT 6531	Ecentric Stop	46	GT 12315	Cover
21	GT 1660	Washer	47	GT 455	Tyre
22	GT 10480	Washer	48	GT 456	Tube
23	GT 2042	Nyloc Nut	49	GT 7007	Front Wheel Hub
24	GT 12366	Tie Rod	50	GT 396	Bearings
25	GT 12860	L.H. King Pin	51	GT 2212	Steering Wheel Complete
26	GT 14630	Axle Beam	52	GT 15815	Roller Chain and Connecting Link

PARTS AND SPECIFICATIONS SUBJECT TO CHANGE WITHOUT NOTICE.

STANDARD HARDWARE ITEMS ARE NOT SHOWN

## Cutter Deck 32"

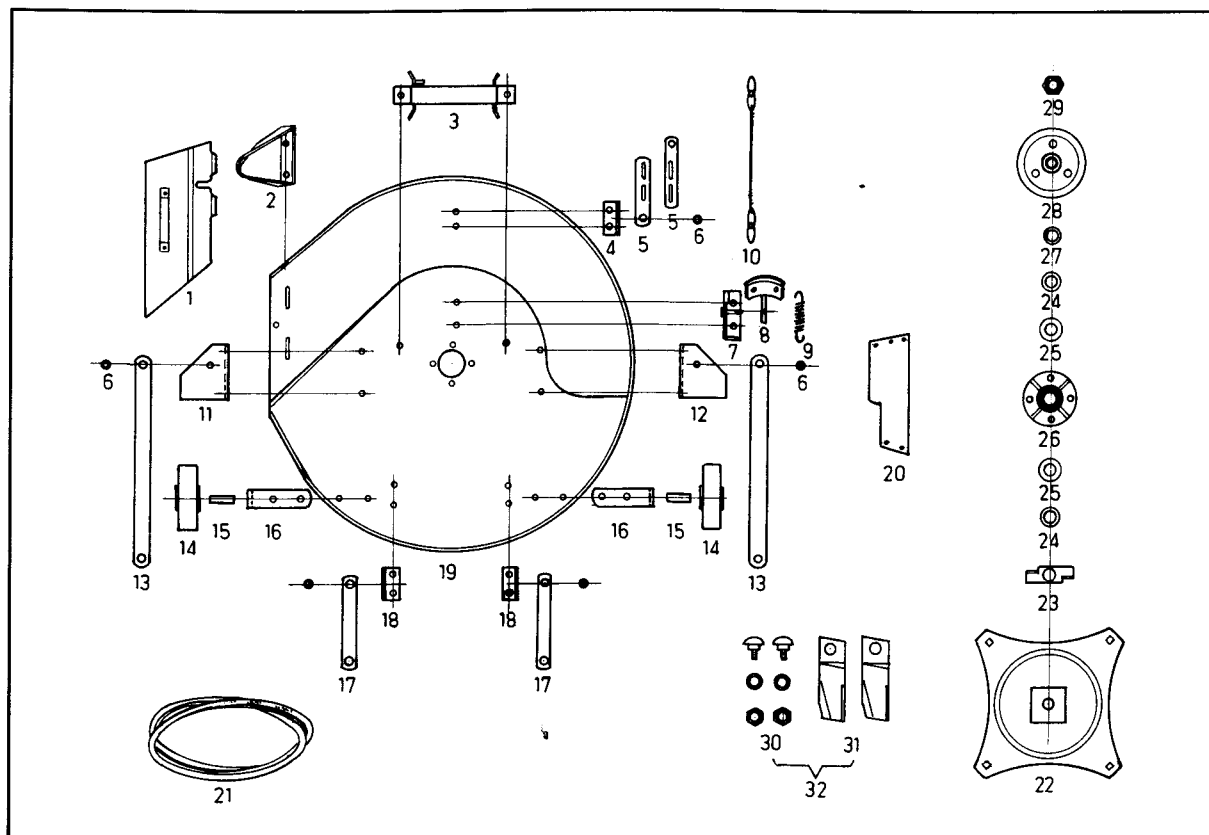

INDEX	PART NO.	DESCRIPTION	INDEX	PART NO.	DESCRIPTION
1	GT 8125	Stone Guard	17	GT 14306	Lifting Link Rear
2	GT 6631	Deck Skid	18	GT 14338	Bracket
3	GT 14775	Belt Guard	19	GT 14335	Cutter Deck
4	GT 14330	Bracket	20	GT 12348	Steel Infill
5	GT 14342	Lifting Link Front	21	GT 14003	"V" Belt
6	GT 730	Pivot Bush	22	GT 14765	Disc and Spindle
7	GT 14725	Bracket	23	GT 8205	Bearing Wiper
8	GT 15814	Cutter Brake Unit.	24	GT 635	Spacer
9	GT 6124	Spring	25	GT 589	Shield
10	GT 15801	Pull Linkage	26	GT 7988	Spindle Housing Unit
11	GT 14334	L.H. Steady	27	GT 241	Spacer
12	GT 14333	R.H. Steady	28	GT 12014	Pulley
13	GT 14303	Link Bar	29	GT 2003	Nut
14	GT 12010	Jockey Wheel	30	GT 2110	Blade Bolt Set
15	GT 8501	Bush	31	GT 2138	Blade Set
16	GT 12362	Bracket	32	GT 2139	Blade and Bolt Set

PARTS AND SPECIFICATIONS SUBJECT TO CHANGE WITHOUT NOTICE.

STANDARD HARDWARE ITEMS ARE NOT SHOWN

# Body Work & Seat

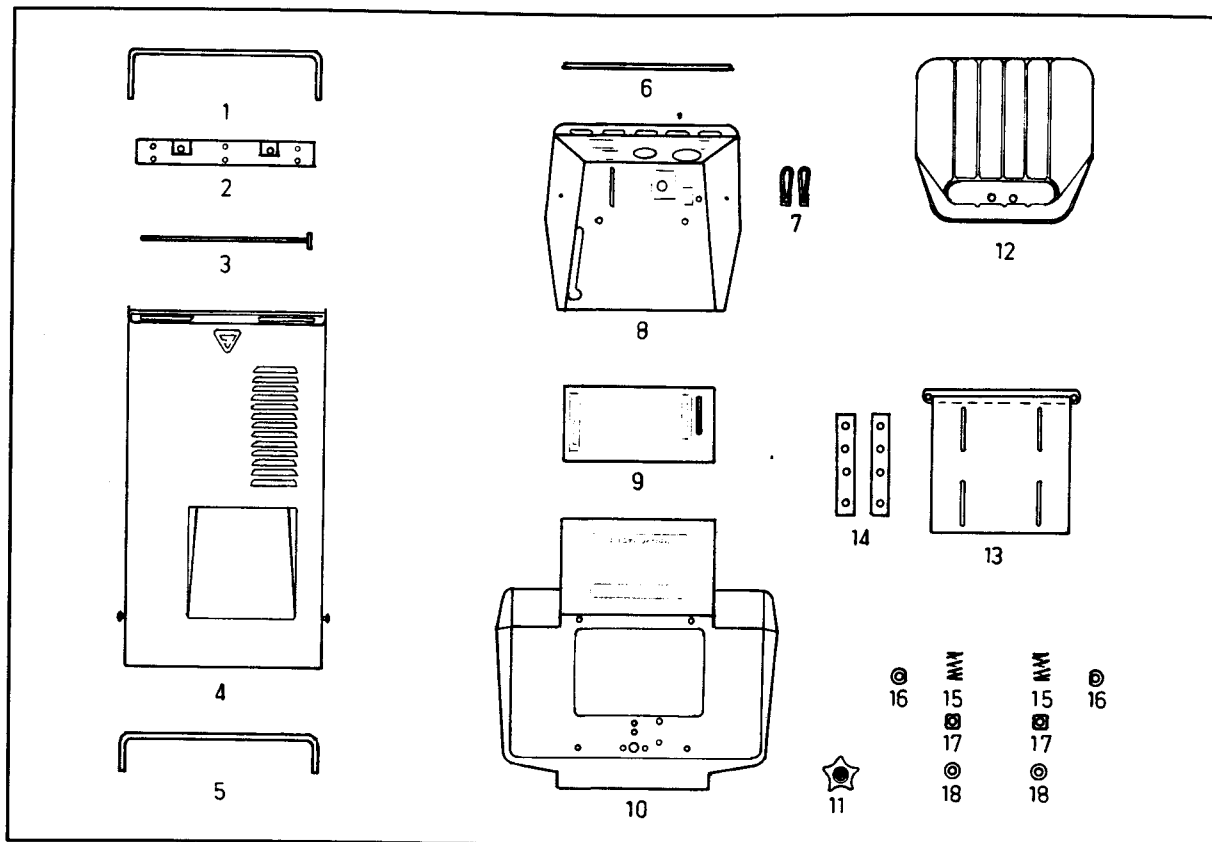

INDEX	PART NO.	DESCRIPTION	INDEX	PART NO.	DESCRIPTION
1	GT 10478	Pinchweld Front	10	GT 14910	Rear Cover, Painted & Decal only
2	GT 6431	Bracket - Headlight Support	11	GT 13807	Knob - Rear Cover
3	GT 8470	Bonnet Pivot Rod	12	GT 8064	Seat
4	GT 15834	Bonnet Unit Complete	13	GT 14940	Hinged Seat Base
4	GT 14695	Bonnet, Painted & Decal Only	14	GT 10508	Packing Strip
5	GT 12355	Pinchweld Rear	15	GT 10005	Spring
6	GT 14347	PVC "U" Strip	16	GT 10452	Clamp
7	GT 7015	Strap	17	GT 10451	Locating Block
8	GT 14985	Steering Cowl, Painted & Decal only	18	GT 1660	Washer
9	GT 14890	Step Through Cover			
	GT 14115	Mower Decal Set B&S engine			
	GT 14113	Mower Decal Set Honda engine			

PARTS AND SPECIFICATIONS SUBJECT TO CHANGE WITHOUT NOTICE.

STANDARD HARDWARE ITEMS ARE NOT SHOWN.

## Guarantee

Greenfield Products Pty Ltd the manufacturer guarantee their product free of faulty workmanship and material for a period of 12 months for domestic use, 3 months for commercial use. Engines and batteries used on Greenfield mowers carry the respective manufacturers warranty.

For details of the Greenfield 3 year extended warranty plan ask your Greenfield dealer.

This Guarantee will not apply to:

- Fair wear and tear, V Belts, Tyres, Tubes, Blades and Blade bolts, Blade holder, and damage caused by misuse, neglect and accidents.
- Repairs rendered necessary or arising from use of other than genuine Greenfield parts, or the relevant genuine engine manufacturers parts.
- Any work performed by other than an authorised Greenfield dealer, or damage arising therefrom.

Products or parts considered faulty should be returned to the authorised Greenfield dealer, or direct to Greenfield with all necessary information, freight paid for inspection. In all warranty claims the manufacturer's decision is final and binding.

The benefits conferred by the above guarantee are in addition to all other rights and remedies in respect of the product which the consumer has under existing laws in Australia and New Zealand.

Greenfield Products Pty Ltd. the manufacturer reserves the right to change parts and specifications without notice.

### Guarantee Registration Details

Owner \_\_\_\_\_

Address \_\_\_\_\_

\_\_\_\_\_ Postcode \_\_\_\_\_

Purchase Date \_\_\_\_\_ Model \_\_\_\_\_

Chassis No. \_\_\_\_\_ Engine No. \_\_\_\_\_

Dealer Name \_\_\_\_\_

Dealer Signature \_\_\_\_\_

Please complete this record which should be held by the purchaser and presented should service under guarantee be required. To register your guarantee please complete the enclosed guarantee card and return to Greenfield Products.

**Greenfield** Products Pty Ltd

172 Ingram Road, Acacia Ridge Qld 4110.

P.O. Box 155 Archerfield Qld 4108 Australia.

Fax: (07) 344 1161. Tel: (07) 345 6100